

ARKANSAS DEPARTMENT OF TRANSPORTATION  
CONSTRUCTION PLANS

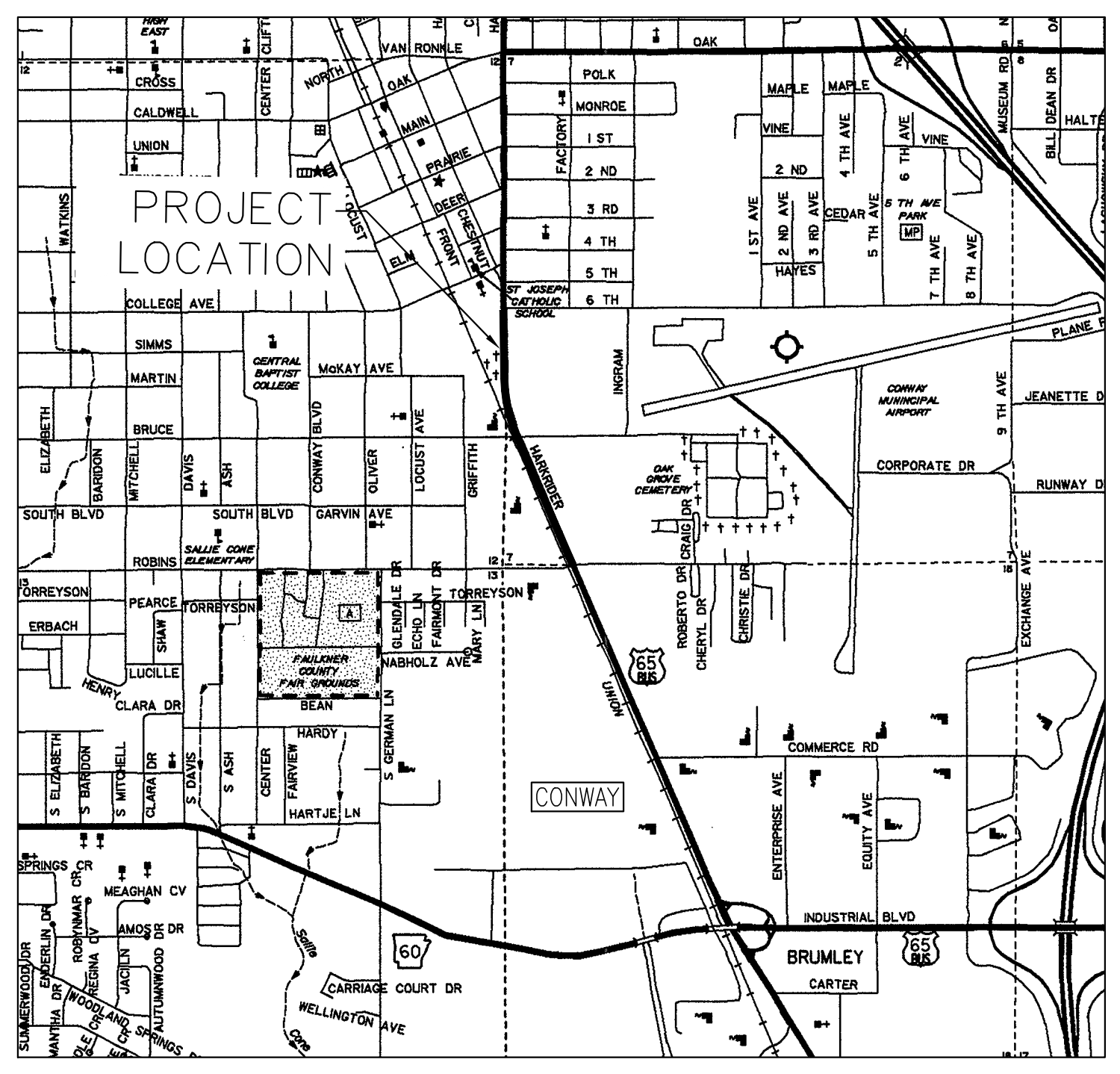

HARKRIDER STREET SIDEWALK  
FAULKNER COUNTY

DATE REVISED	DATE FILMED	DATE REVISED	DATE FILMED	FED. RD. DIST. NO.	STATE	FED. AID PROJ. NO.	SHEET NO.	TOTAL SHEETS
				6	ARK.			
						JOB NO.	061527	1
						2 HARKRIDER ST. SIDEWALK		



VICINITY MAP

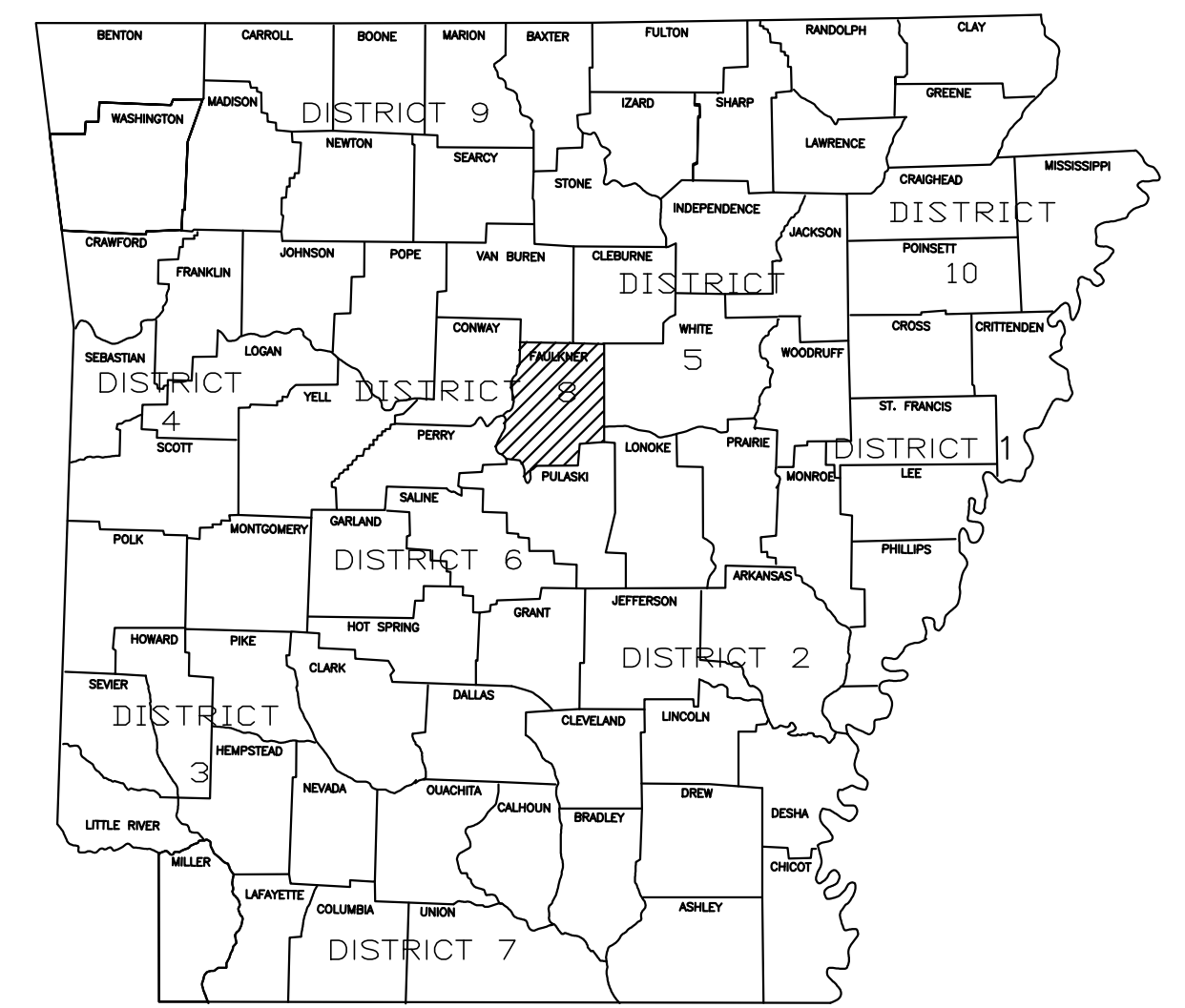

ARK. HIGHWAY DIST. 8

NOT TO SCALE

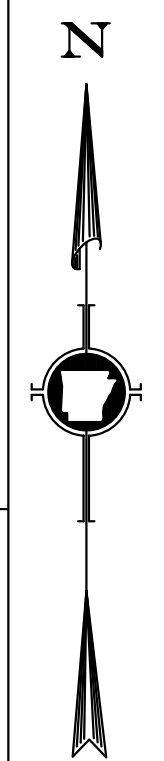
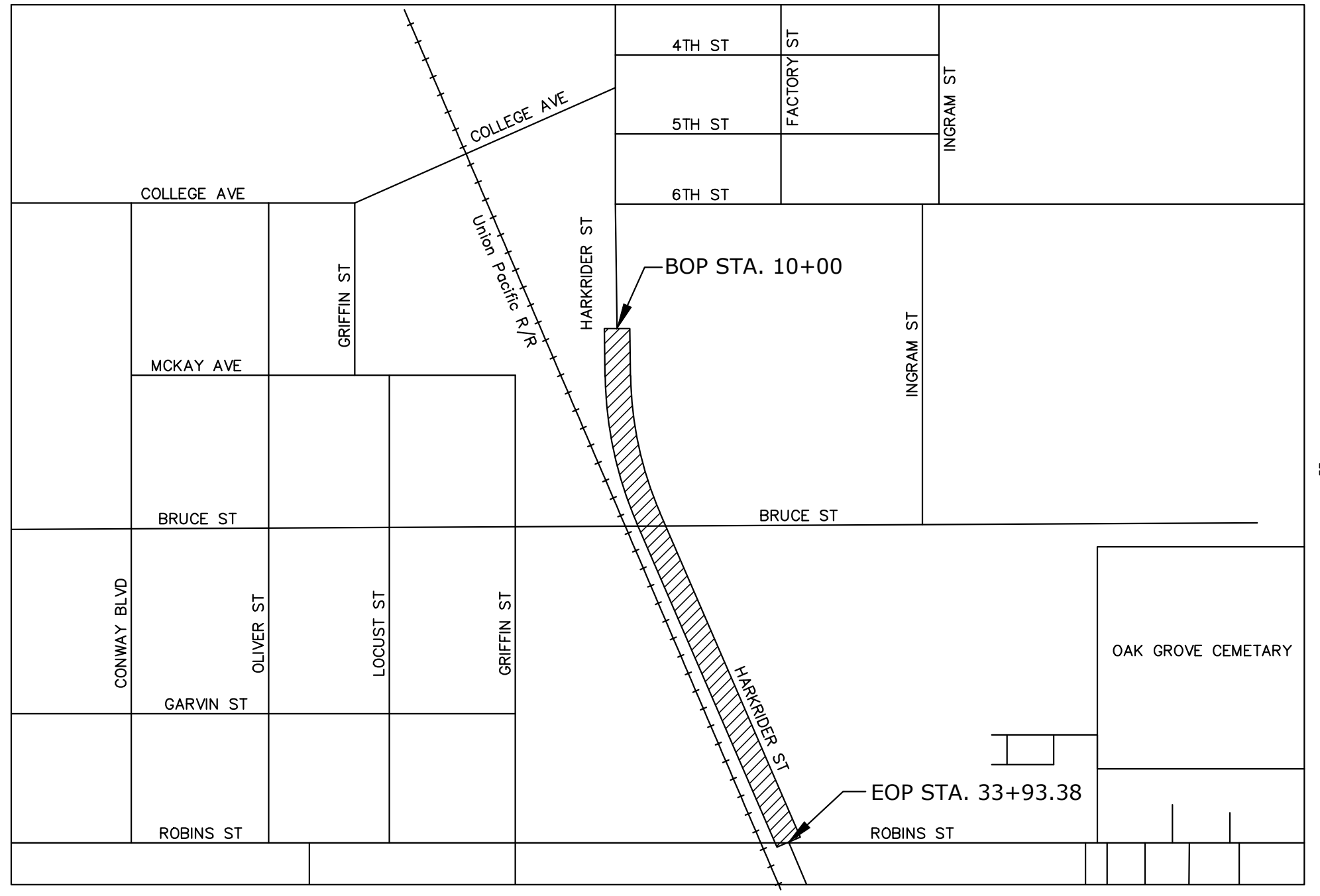

T 3 N

R 10 W

30% DESIGN

HARKRIDER ST. SAFE ROUTES TO SCHOOL SIDEWALK

	BEGIN PROJECT	MID-POINT PROJECT	END PROJECT
LATITUDE			
LONGITUDE			

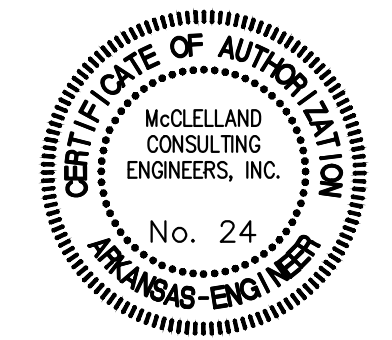

W:\2019\19-5755 Conway Harkrider St. Safe Routes to School Sidewalk\Design Drawings\Civil\19-5755-COVER.dwg 5/24/19 at 1:46pm

DATE REVISED	DATE FILMED	DATE REVISED	DATE FILMED	FED. RD. DIST. NO.	STATE	FED. AID PROJ. NO.	SHEET NO.	TOTAL SHEETS
				6	ARK.			
						JOB NO. 061527	2	11

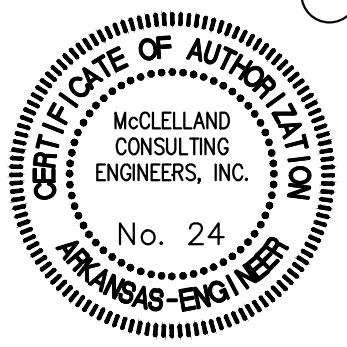

2 INDEX OF SHEETS AND GENERAL NOTES

INDEX OF SHEETS			
SHEET NO.	SHEET TITLE	DRAWING NO.	DATE
1	TITLE SHEET		
2	INDEX OF SHEETS & GENERAL NOTES		
3	SURVEY DATA SHEET		
4	SURVEY DATA SHEET		
5	SURVEY DATA SHEET		
6	TYPICAL SECTIONS OF IMPROVEMENT		
7	PLAN AND PROFILE		
8	PLAN AND PROFILE		
9	PLAN AND PROFILE		
10	PLAN AND PROFILE		
11	PLAN AND PROFILE		

GENERAL NOTES:

- ALL STORM WATER STRUCTURE MANHOLE LIDS SHALL BE "CITY OF BENTONVILLE" STORM SEWER LIDS WITH FISH AND VEGETATION EMBLEM.
- NO UNDERGROUND STORM SEWER OR SANITARY SEWER STRUCTURES SHALL HAVE STEPS OR RUNGS PER CITY OF BENTONVILLE STANDARDS. WHEN REFERENCING AHTD STANDARD DRAWINGS, CONTRACTOR SHALL DISREGARD THESE ITEMS DURING CONSTRUCTION.
- ALL TREES THAT DO NOT DIRECTLY INTERFERE WITH PROPOSED CONSTRUCTION SHALL BE SPARED AS DIRECTED BY ENGINEER. CONTRACTOR SHALL INSURE THAT ALL TREES NOT TO BE REMOVED SHALL BE HARMED AS LITTLE AS POSSIBLE DURING THE CONSTRUCTION.
- ANY EQUIPMENT OR APPURTENANCE THAT INTERFERES WITH PROPOSED CONSTRUCTION AND WHICH MAY BE PROPERTY OF UTILITY COMPANIES SHALL BE MOVED BY OWNERS UNLESS OTHERWISE NOTED.
- POWER POLES, FIRE HYDRANTS, AND OTHER ABOVE GROUND UTILITIES SHALL NOT BE PLACED IN SIDEWALKS UNLESS APPROVED BY ENGINEER.
- LOCATION OF KNOWN SUBSURFACE STRUCTURES, PIPE, POWER, GAS, PHONE LINES, ETC. ARE SHOWN ON PLANS, CONTRACTOR SHALL BE RESPONSIBLE FOR OBTAINING INFORMATION AND SATISFYING HIMSELF AS TO THE LOCATION OF AFOREMENTIONED ITEMS, SHOWN AND NOT SHOWN. ALL REPAIRS NECESSARY SHALL BE MADE AS REQUIRED BY OWNER OF UTILITY OR STRUCTURE. COST OF SUCH REPAIRS NECESSARY SHALL BE BORNE BY THE CONTRACTOR.
- ALL UTILITIES ARE TO BE MOVED OR LOWERED BY THE RESPECTIVE OWNERS.
- ALL STREETS AND DRIVES, WALKS, DRAINAGE STRUCTURES, FENCES, ETC. THAT ARE DAMAGED OR DISTURBED SHALL BE RESTORED TO THEIR ORIGINAL OR BETTER CONDITION USING LIKE OR BETTER MATERIALS. PAYMENT WILL BE CONSIDERED INCLUDED IN THE PRICE BID FOR THE VARIOUS BID ITEMS.
- CONTRACTOR IS REQUIRED TO NOTIFY THE ONE CALL CENTER 48 HOURS PRIOR TO DIGGING IN ORDER THAT UNDERGROUND UTILITIES MAY BE LOCATED.
- THE CONTRACTOR SHALL BE RESPONSIBLE FOR MAINTAINING MAILBOXES WITHIN THE PROJECT LIMITS IN SUCH A MANNER THAT THE PUBLIC MAY RECEIVE CONTINUED MAIL SERVICE. PAYMENT WILL BE CONSIDERED INCLUDED IN THE PRICE BID FOR THE VARIOUS BID ITEMS.
- CONTRACTOR TO ADJUST SANITARY SEWER MANHOLES, WATER VALVES, AND FIRE HYDRANTS TO GRADE. PAYMENT WILL BE CONSIDERED INCLUDED IN THE PRICE BID FOR THE VARIOUS BID ITEMS.
- THE EXISTING ASPHALT PAVEMENT TO BE REMOVED FROM THE REMAINING PAVEMENT SHALL BE SEPARATED BY SAWING ALONG A NEAT LINE. AFTER SAWING THE PAVEMENT TO BE REMOVED SHALL BE REMOVED CAREFULLY IN A MANNER THAT WILL NOT DAMAGE THE PAVEMENT THAT IS TO REMAIN. ANY DAMAGE OF THE ASPHALT PAVEMENT THAT IS TO REMAIN SHALL BE REPAIRED AT THE CONTRACTOR'S EXPENSE.
- CONTRACTOR SHALL USE CONCRETE OR NON-SHRINK GROUT TO PLUG ENDS OF ALL ABANDONED WATER AND SANITARY SEWER PIPES CUT DURING CONSTRUCTION. PAYMENT WILL BE CONSIDERED INCLUDED IN THE PRICE BID FOR THE VARIOUS BID ITEMS.
- THE CONTRACTOR SHALL MAINTAIN ACCESS FOR THE SAFE AND CONVENIENT USE OF THE ADJACENT PROPERTY OWNERS.

DATE REVISED	DATE FILED	DATE REVISED	DATE FILED	FED. RD. DIST. NO.	STATE	FED. AID PROJ. NO.	SHEET NO.	TOTAL SHEETS
				6	ARK.		3	11
				JOB NO.		061527	SURVEY - HARKRIDER ST. SIDEWALK	

**LEGEND**

- ▲ SURVEY CONTROL MONUMENT (TYPE AS NOTED)
- FOUND SURVEY BOUNDARY MARKER (TYPE AS NOTED)
- STORM DRAIN GRATE
- ⊙ STORM WATER MANHOLE
- ⊙ SANITARY SEWER MANHOLE
- ⊙ LIGHT POLE
- ⊙ POWER POLE
- ⊙ GUY LINE
- ⊙ TELEPHONE PEDESTAL
- ⊙ MANHOLE OTHER
- ⊙ GAS METER
- ⊙ WATER VALVE
- ⊙ WM WATER METER
- ⊙ FH FIRE HYDRANT
- ⊙ CONIFER TREE
- ⊙ TREE (TYPE AS NOTED)
- ⊙ BUSH
- ⊙ SIGN
- ⊙ POST OR POLE (TYPE AS NOTED)
- ⊙ TRAFFIC SIGNAL CONTROL VAULT
- ⊙ ELECTRIC BOX

- CURB LINE
- OVERHEAD ELECTRIC LINE
- FENCE
- STORM WATER LINE
- SANITARY SEWER LINE
- RIGHT OF WAY LINE
- DITCH OR STREAM LINE

**SURVEYOR'S NOTES:**

HORIZONTAL COORDINATES FOR THIS PROJECT ARE ARKANSAS STATE PLANE NORTH ZONE, NAD83 AND ELEVATIONS ARE NAVD83 BASED ON C.A.G.I.S. MONUMENT 1001, A 3" ALUMINUM CAP SET IN CONCRETE.

CONTOUR INTERVAL = 1 FOOT.

THIS IS A TOPOGRAPHIC SURVEY ONLY AND IN NO WAY SHOULD BE INTERPRETED AS A PROPERTY BOUNDARY SURVEY. ANY PROPERTY LINES SHOWN ARE FOR REFERENCE ONLY AND HAVE NOT BEEN VERIFIED.

RIGHT OF WAY LINES SHOWN ARE SHOWN IN AN APPROXIMATE LOCATION AND SHOULD BE USED FOR REFERENCE ONLY.

FIELD WORK FOR THIS SURVEY WAS COMPLETED APRIL, 2019.

NO STATEMENT IS MADE CONCERNING SUBSURFACE CONDITIONS.

BURIED UTILITIES AND SUBSURFACE STRUCTURES ARE SHOWN BASED ON VISUAL INSPECTION OF MANHOLES AND OTHER SURFACE FEATURES. McCLELLAND CONSULTING ENGINEERS HAS ACCURATELY DEPICTED THE UNDERGROUND AND SUBSURFACE FEATURES TO THE BEST OF THEIR KNOWLEDGE AND ABILITY. ANY CONSTRUCTION AT THIS SITE SHOULD ONLY BE DONE AFTER CONTACTING ARKANSAS ONE CALL AT 1-800-482-8998 AT LEAST 48 HOURS PRIOR TO ANY EXCAVATION.

MANHOLE AND DRAIN GRATE INFORMATION WERE GATHERED BY VISUAL INSPECTION AND ARE CONNECTED AND DESCRIBED ONLY AS COULD BE DETERMINED THROUGH SAID VISUAL INSPECTION.

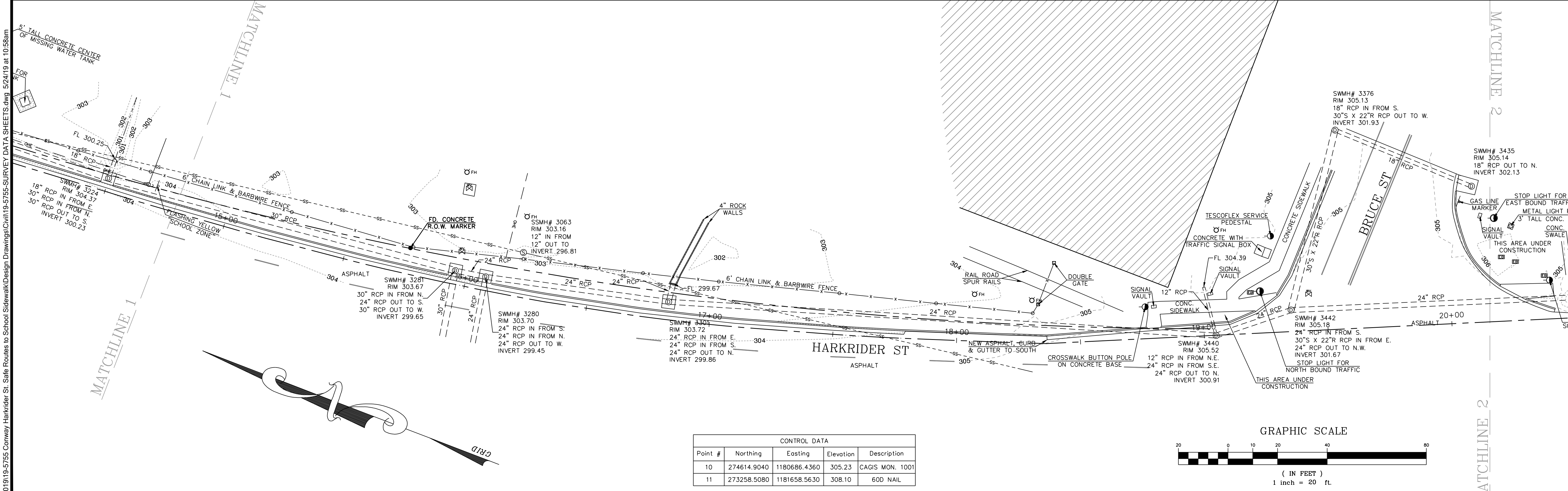
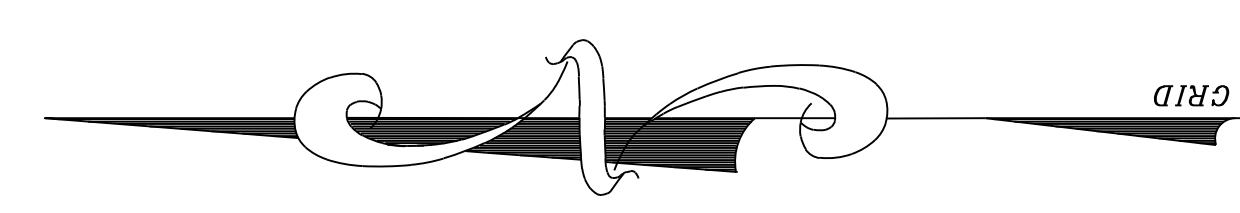
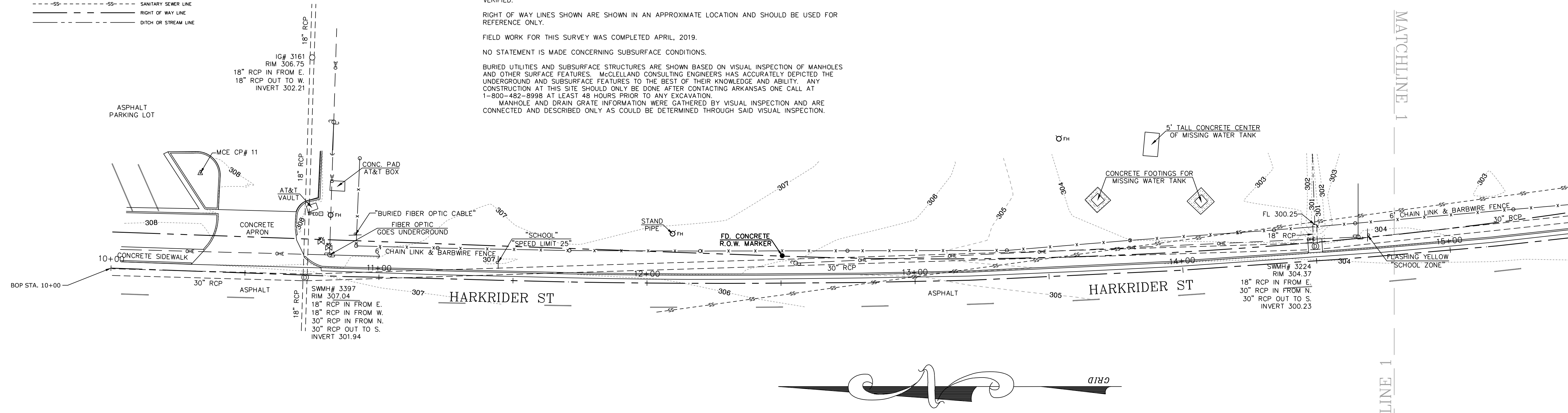

**CONTROL DATA**

Point #	Northing	Easting	Elevation	Description
10	274614.9040	1180686.4360	305.23	CAGIS MON. 1001
11	273258.5080	1181658.5630	308.10	60D NAIL

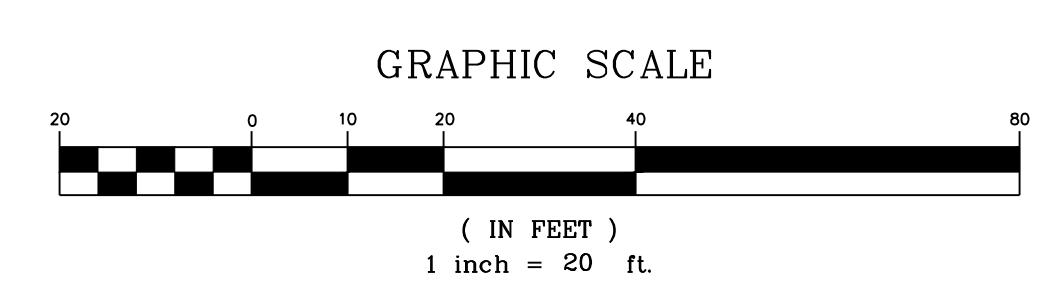

W:201919-5755 Conway Harkrider St. Safe Routes to School Sidewalk Design Drawings\Civil\19-5755-SURVEY DATA SHEETS.dwg 5/24/19 at 10:58am

DATE REVISED	DATE FILMED	DATE REVISED	DATE FILMED	FED. RD. DIST. NO.	STATE	FED. AID PROJ. NO.	SHEET NO.	TOTAL SHEETS
				6	ARK.			
JOB NO. 061527						4		11
② SURVEY - HARKRIDER ST. SIDEWALK								

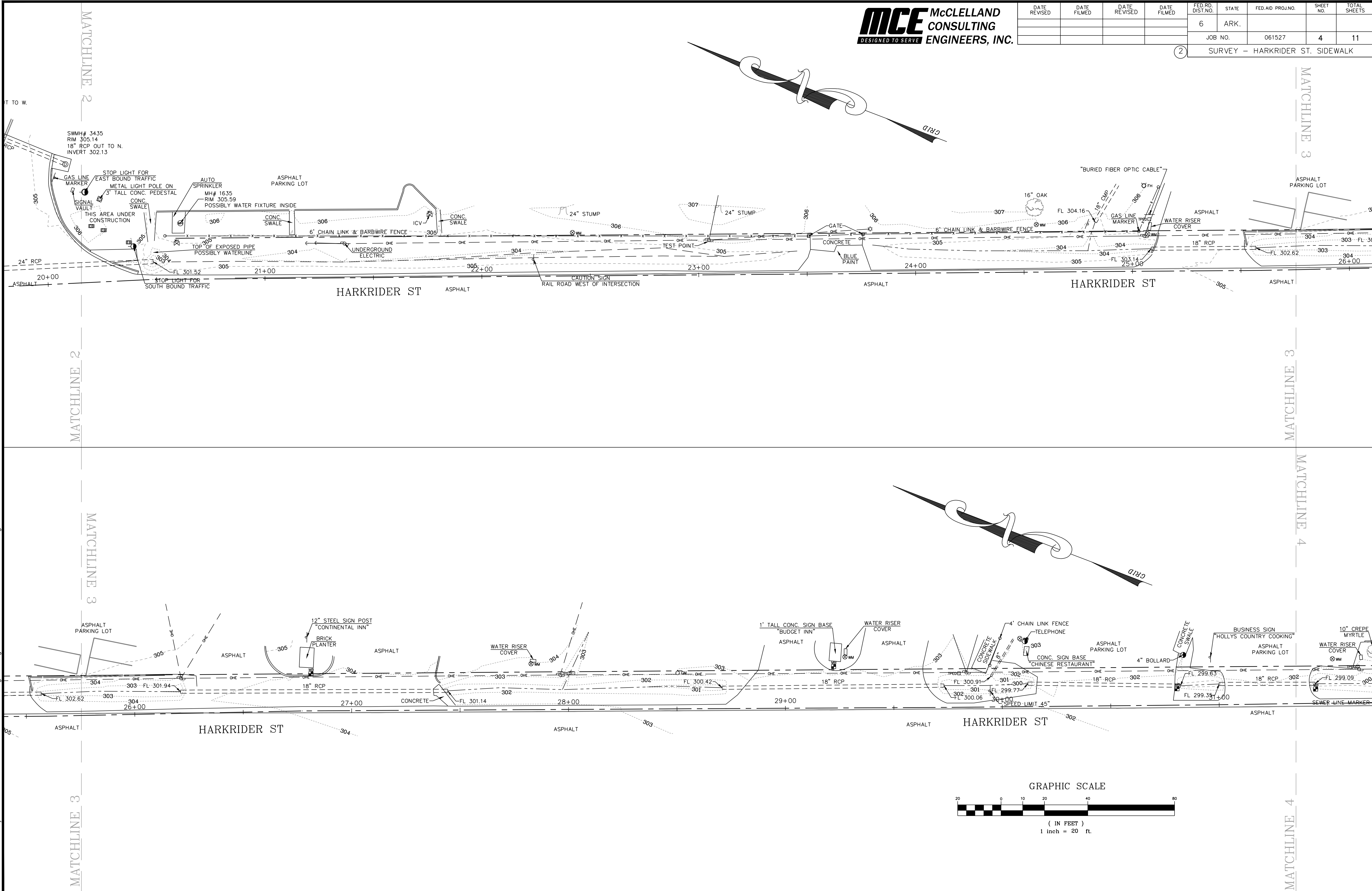

W:\2019\19-5755 Conway Harkrider St. Safe Routes to School Sidewalk\Design Drawings\Civil\19-5755-SURVEY DATA SHEETS.dwg 5/24/19 at 10:58am

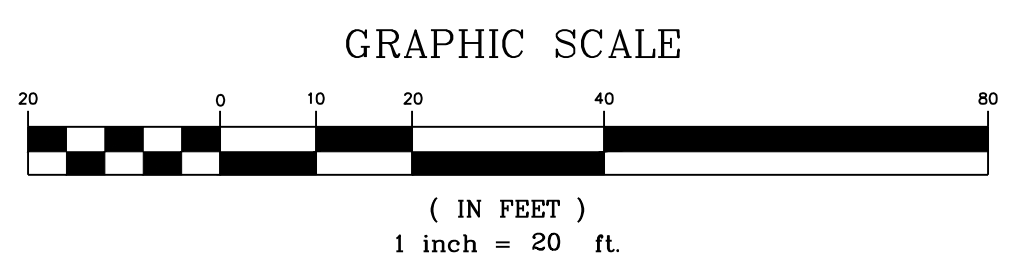

DATE REVISED	DATE FILMED	DATE REVISED	DATE FILMED	FED. RD. DIST. NO.	STATE	FED. AID PROJ. NO.	SHEET NO.	TOTAL SHEETS
				6	ARK.			
						JOB NO.	061527	5
						SURVEY - HARKRIDER ST. SIDEWALK		

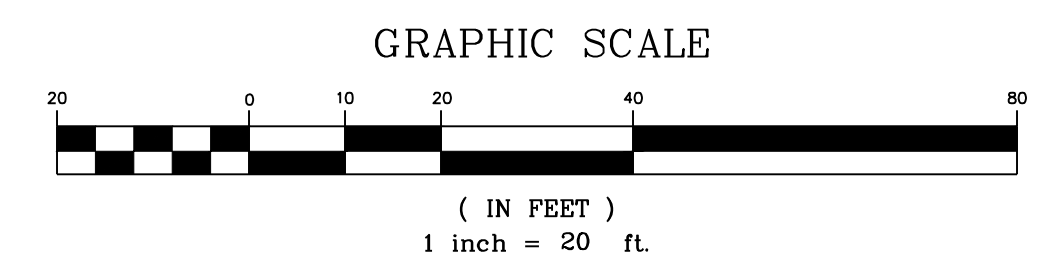
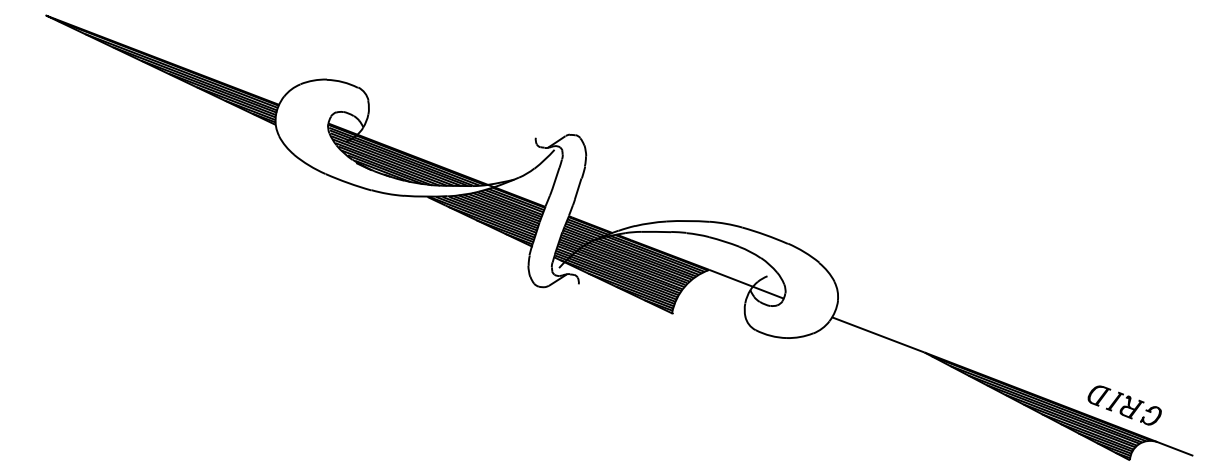
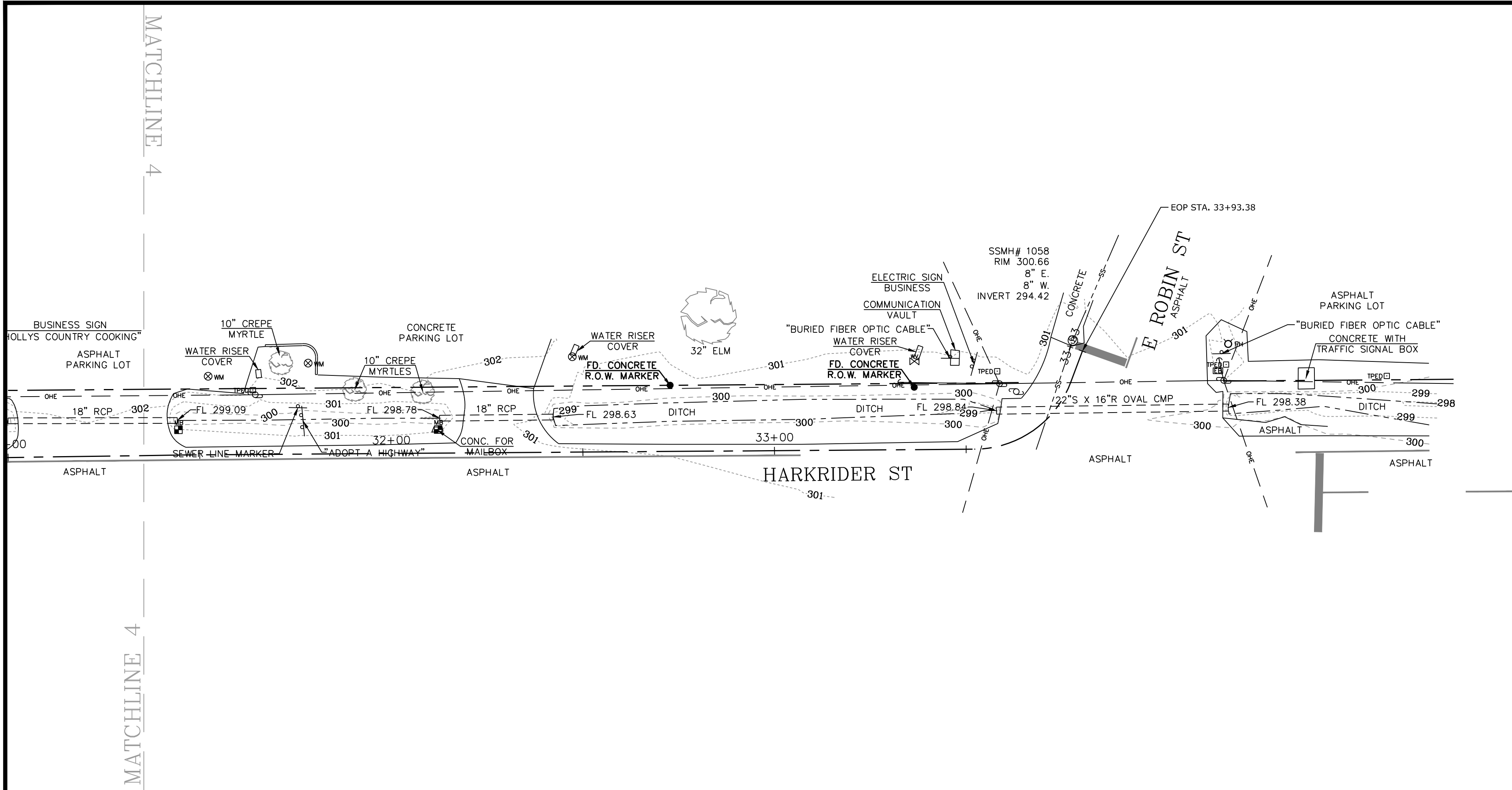

W:\2019\19-5755 Conway Harkrider St. Safe Routes to School Sidewalk\Design Drawings\Civil\19-5755-SURVEY DATA SHEETS.dwg 5/24/19 at 11:01am

DATE REVISED	DATE FILMED	DATE REVISED	DATE FILMED	FED. RD. DIST. NO.	STATE	FED. AID PROJ. NO.	SHEET NO.	TOTAL SHEETS
				6	ARK.			
				JOB NO.	061527	6	11	

② TYPICAL SECTIONS OF IMPROVEMENT

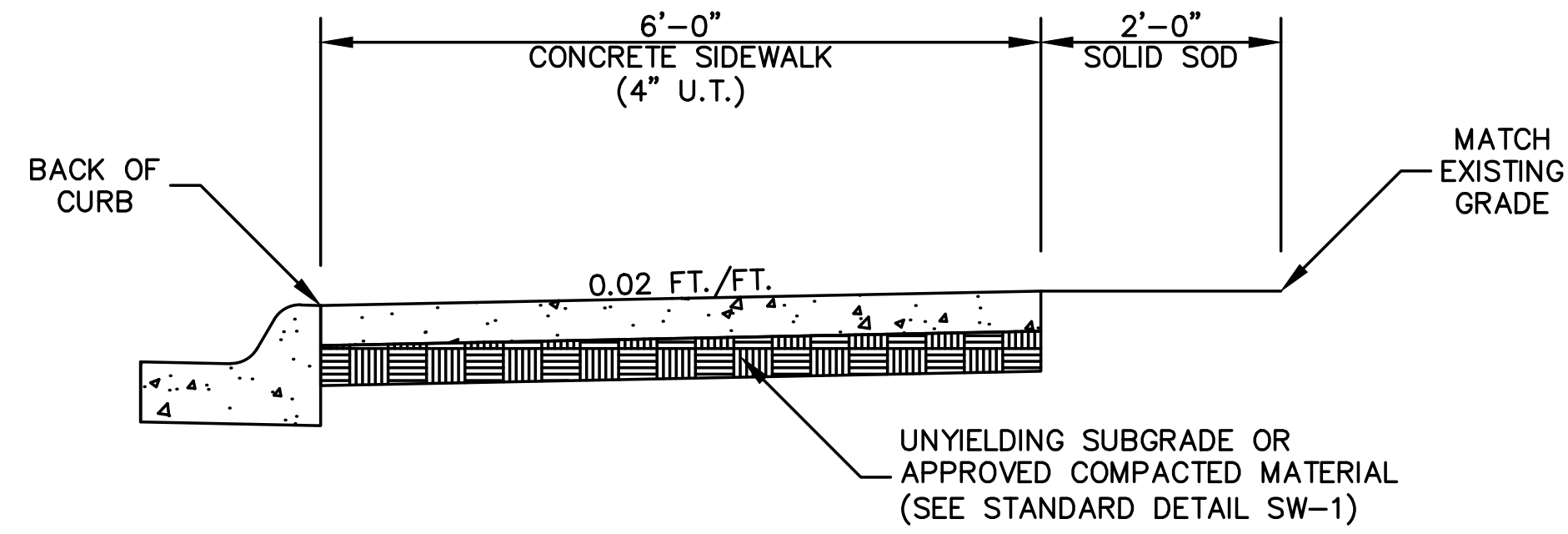

TYPICAL SECTION  
CONCRETE SIDEWALK  
HARKRIDER ST.

REFER TO CROSS SECTIONS FOR DEVIATION FROM THE NORMAL SLOPES. NO CHANGES SHALL BE MADE FROM THE PLANNED SLOPES WITHOUT THE APPROVAL OF THE ENGINEER.

THE THICKNESS OF AGGREGATE BASE COURSE SHALL BE WITHIN PLUS OR MINUS ONE INCH (1") OF THE PLAN THICKNESS SHOWN. THE CONTRACTOR WILL CORRECT ANY DEFICIENT THICKNESS THAT DOES NOT MEET TOLERANCE INDICATED. PAYMENT WILL NOT BE MADE FOR MATERIAL PLACE IN EXCESS OF THE TOLERANCE INDICATED.

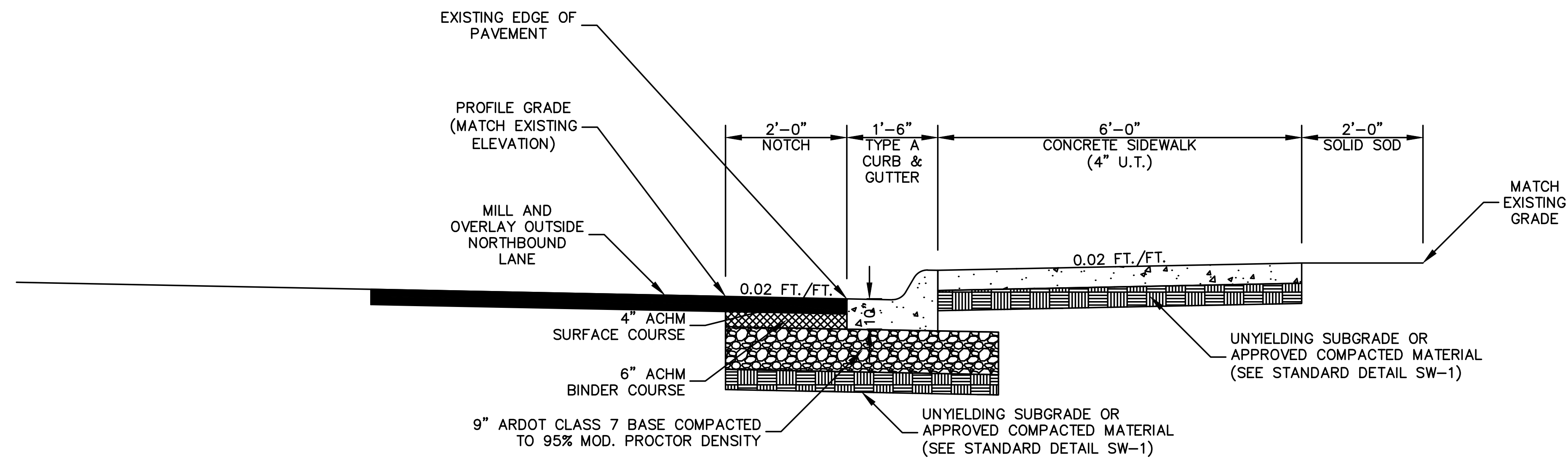

TYPICAL SECTION  
CONCRETE SIDEWALK  
HARKRIDER ST.

DATE REVISED	DATE FILMED	DATE REVISED	DATE FILMED	FED. RD. DIST. NO.	STATE	FED. AID PROJ. NO.	SHEET NO.	TOTAL SHEETS
				6	ARK.			
						JOB NO.	061527	7
						PLAN - HARKRIDER ST. SIDEWALK		

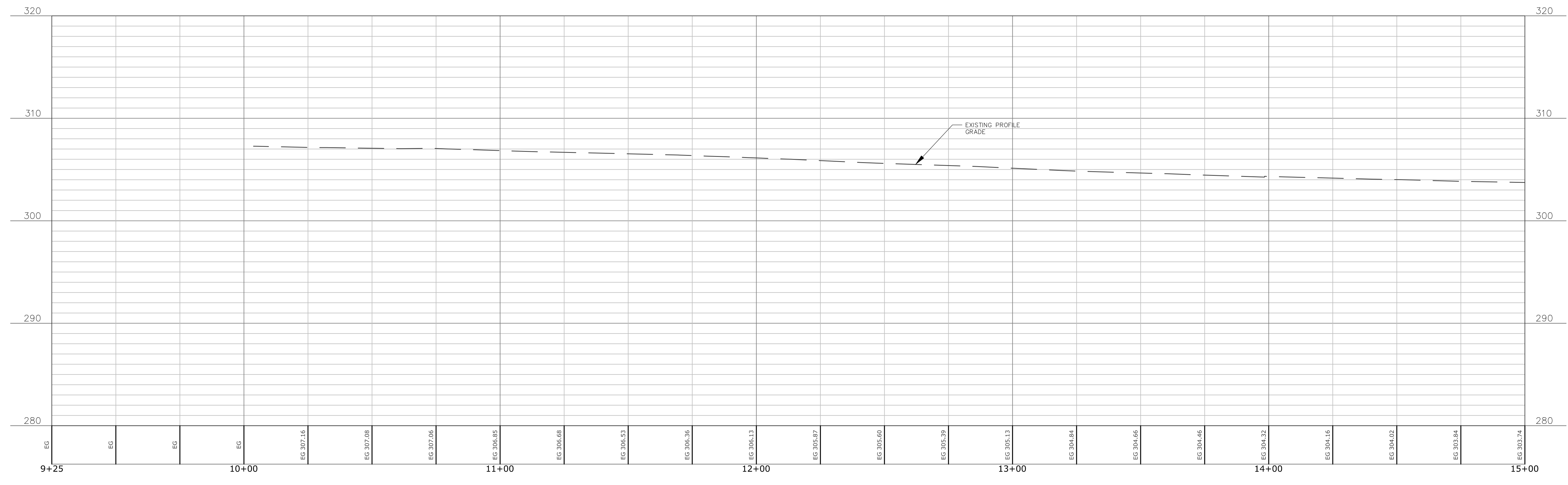
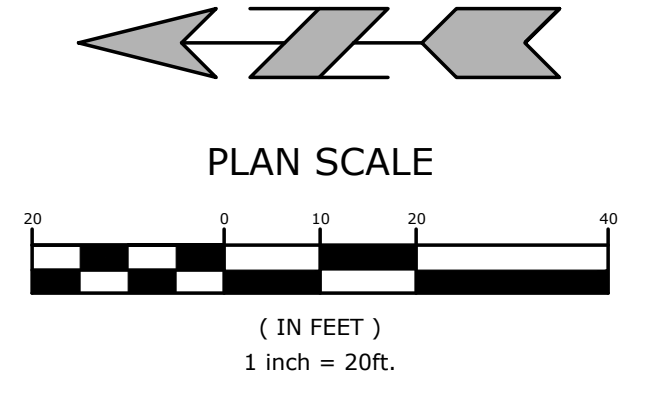
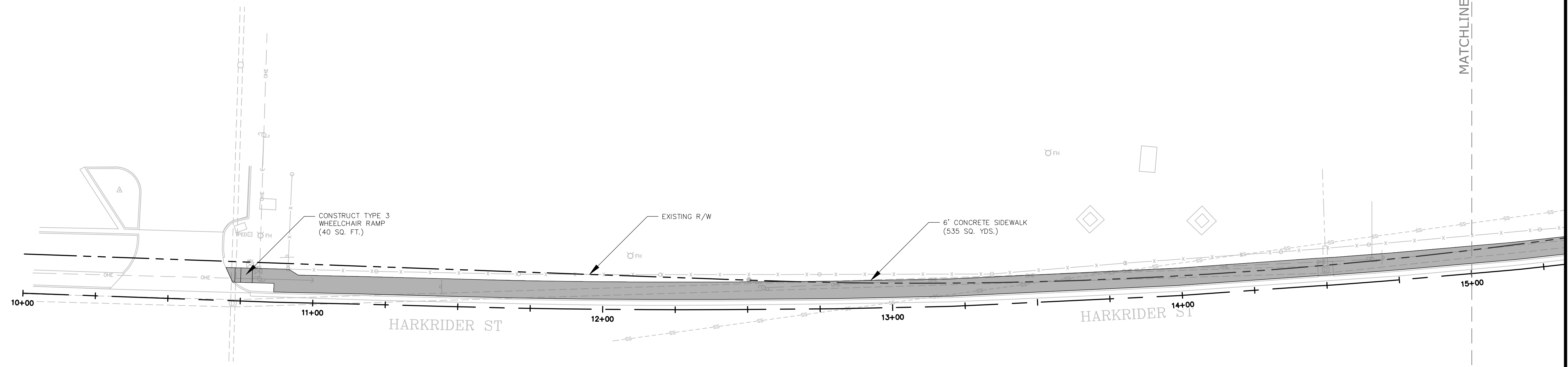

W:\2019\19-5755 Conway Harkrider St. Safe Routes to School Sidewalk\Design Drawings\Civil\19-5755-DESIGN.dwg 5/24/19 at 11:06am

DATE REVISED	DATE FILMED	DATE REVISED	DATE FILMED	FED. RD. DIST. NO.	STATE	FED. AID PROJ. NO.	SHEET NO.	TOTAL SHEETS
				6	ARK.			
JOB NO. 061527							8	11

② PLAN - HARKRIDER ST. SIDEWALK

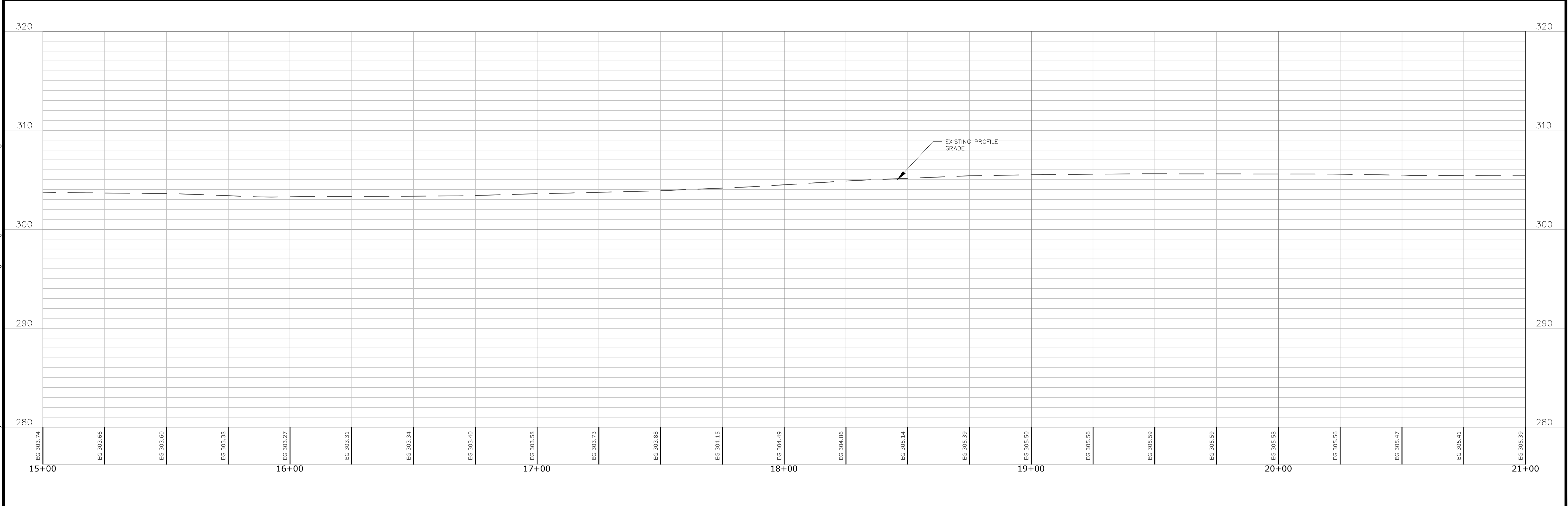
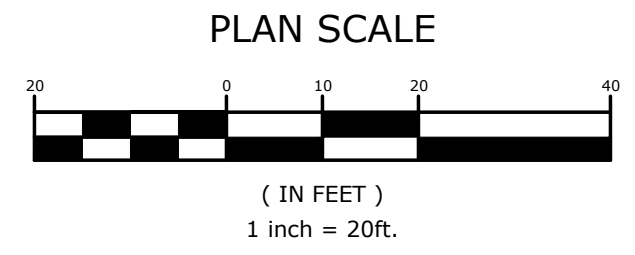
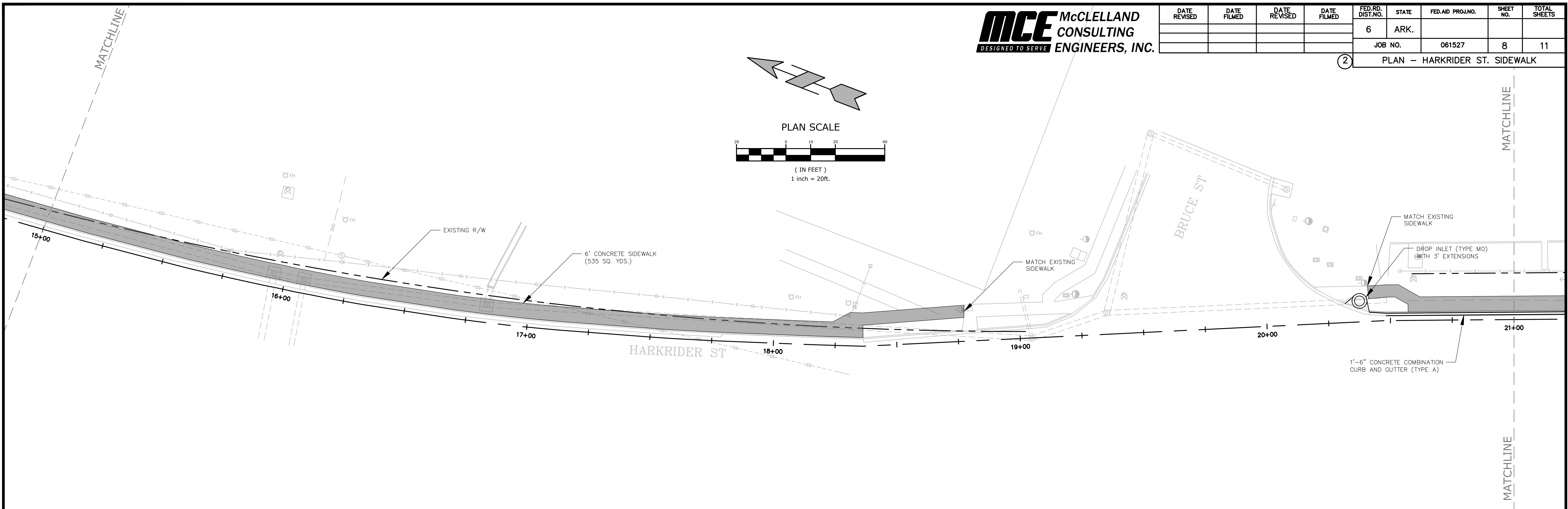

W:\2019\19-5755 Conway Harkrider St. Safe Routes to School Sidewalk\Design Drawings\Civil\19-5755-DESIGN.dwg 5/24/19 at 11:07am

EG 303.74	EG 303.66	EG 303.60	EG 303.38	EG 303.27	EG 303.31	EG 303.34	EG 303.40	EG 303.58	EG 303.73	EG 303.88	EG 304.15	EG 304.49	EG 304.86	EG 305.14	EG 305.39	EG 305.50	EG 305.56	EG 305.59	EG 305.59	EG 305.58	EG 305.56	EG 305.47	EG 305.41	EG 305.39
-----------	-----------	-----------	-----------	-----------	-----------	-----------	-----------	-----------	-----------	-----------	-----------	-----------	-----------	-----------	-----------	-----------	-----------	-----------	-----------	-----------	-----------	-----------	-----------	-----------



DATE REVISED	DATE FILMED	DATE REVISED	DATE FILMED	FED. RD. DIST. NO.	STATE	FED. AID PROJ. NO.	SHEET NO.	TOTAL SHEETS
				6	ARK.			
JOB NO. 061527							9	11

② PLAN - HARKRIDER ST. SIDEWALK

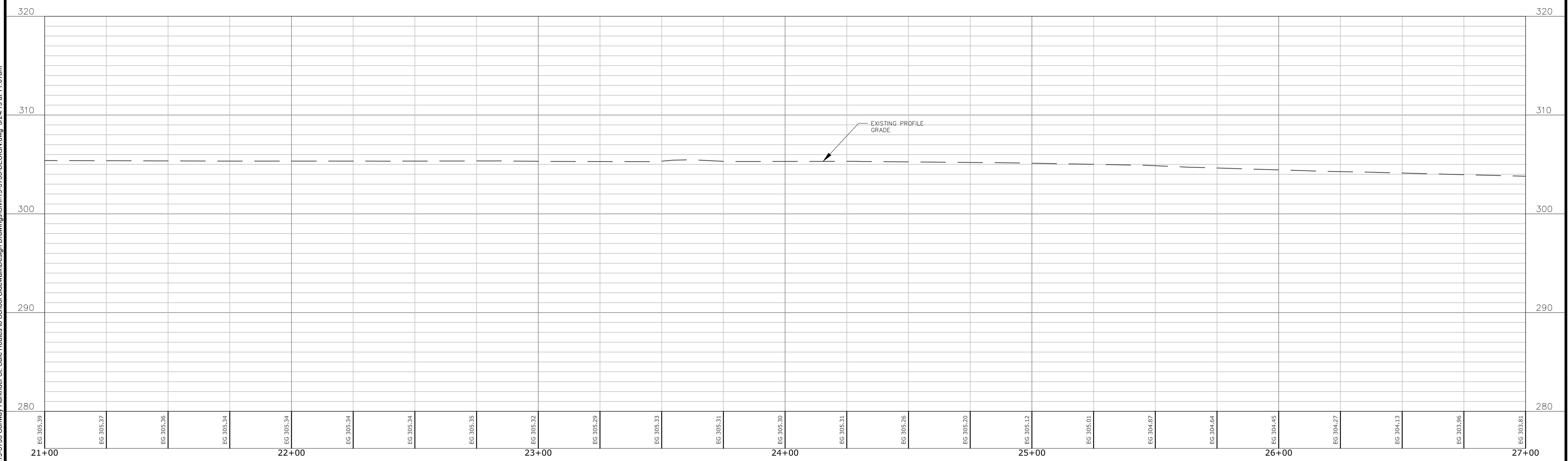
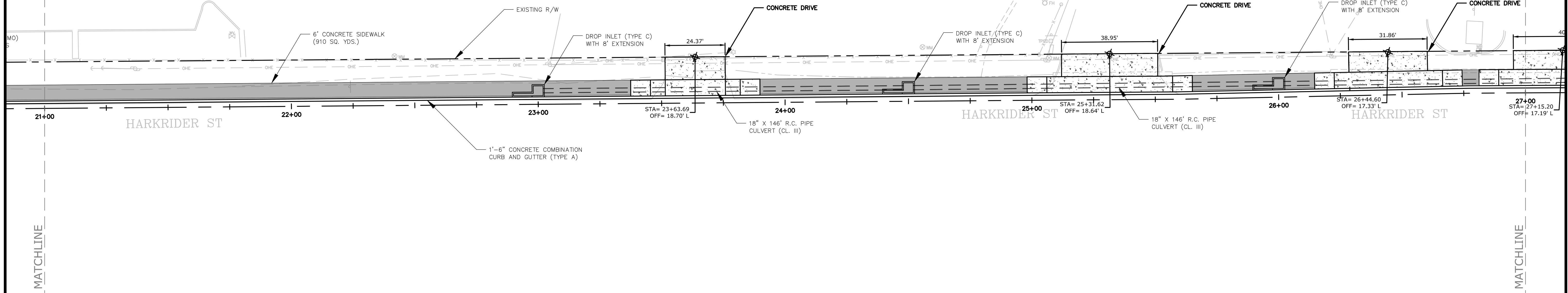
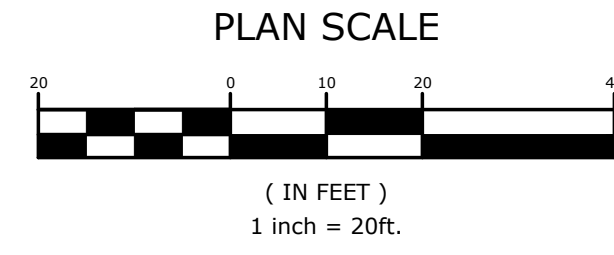
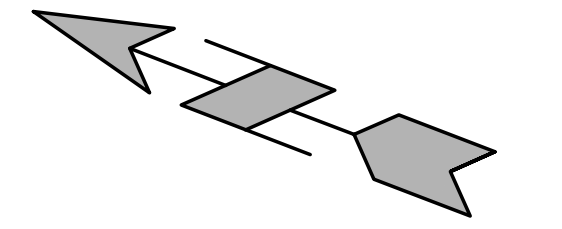

W:\2019\19-5755 Conway Harkrider St. Safe Routes to School Sidewalk\Design Drawings\Civil\19-5755-DESIGN.dwg 5/24/19 at 11:07am

DATE REVISED	DATE FILMED	DATE REVISED	DATE FILMED	FED. RD. DIST. NO.	STATE	FED. AID PROJ. NO.	SHEET NO.	TOTAL SHEETS
				6	ARK.			
JOB NO. 061527							10	11

② PLAN - HARKRIDER ST. SIDEWALK

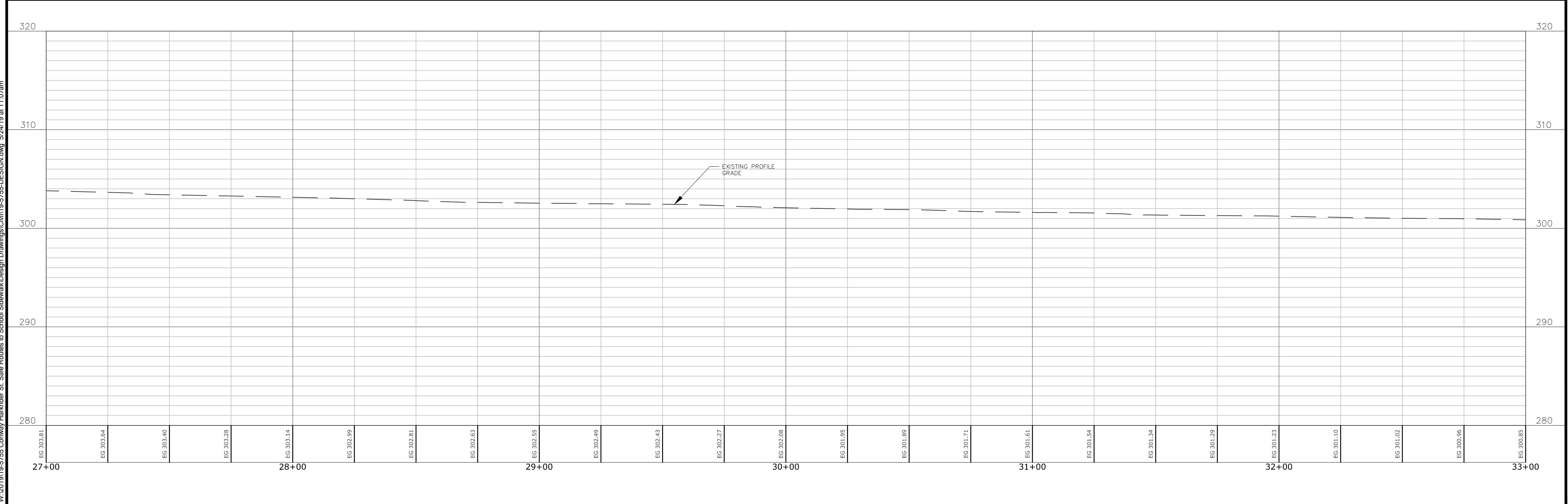
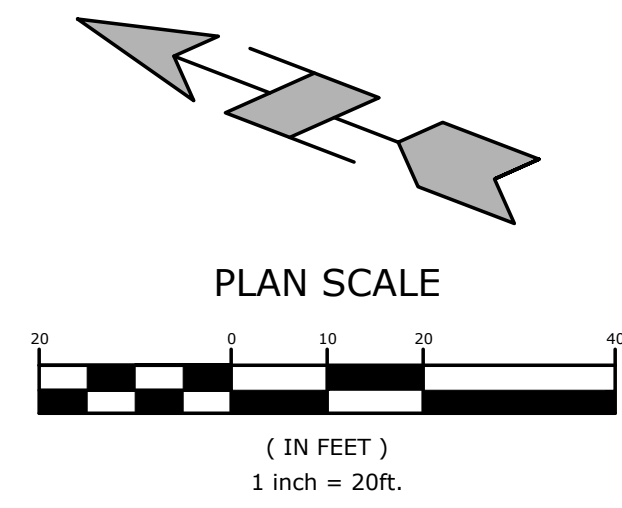
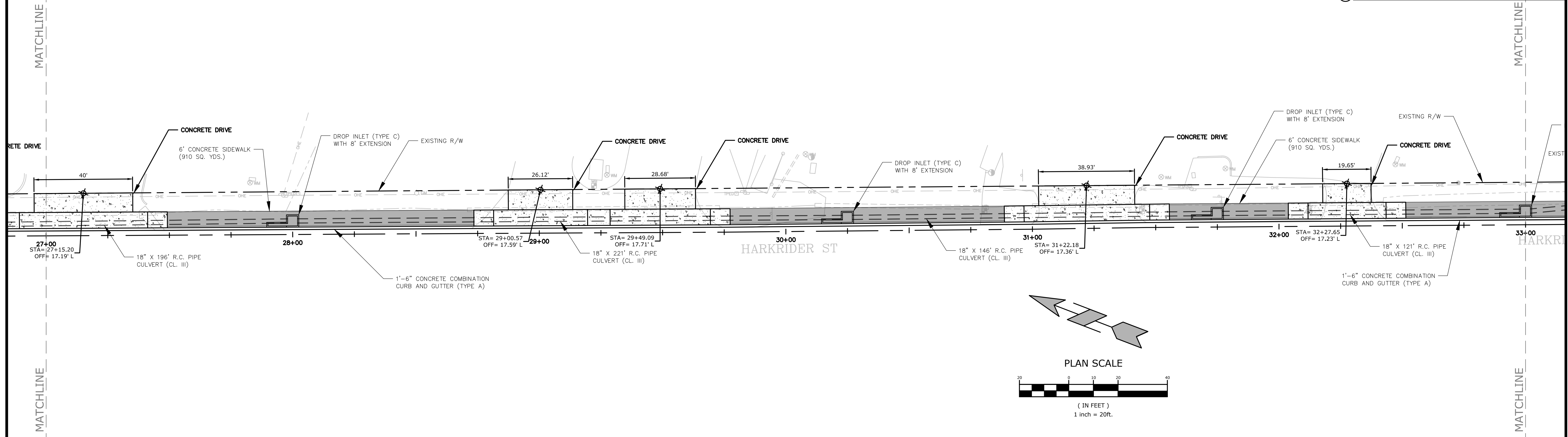

W:\2019\19-5755 Conway Harkrider St. Safe Routes to School Sidewalk\Design Drawings\Civil\19-5755-DESIGN.dwg 5/24/19 at 11:07am

DATE REVISED	DATE FILMED	DATE REVISED	DATE FILMED	FED. RD. DIST. NO.	STATE	FED. AID PROJ. NO.	SHEET NO.	TOTAL SHEETS
				6	ARK.			
				JOB NO.	061527	11	11	

② PLAN - HARKRIDER ST. SIDEWALK

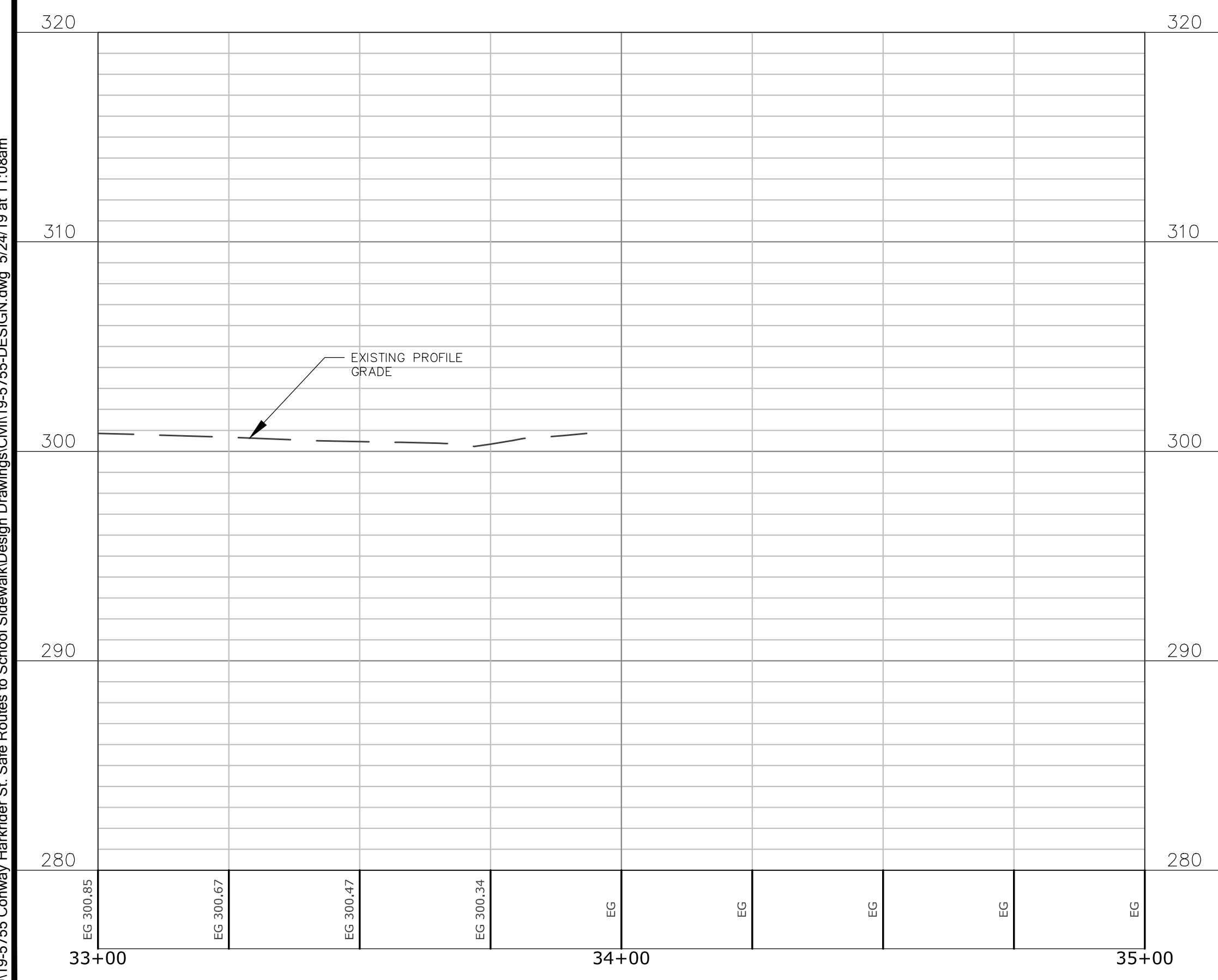
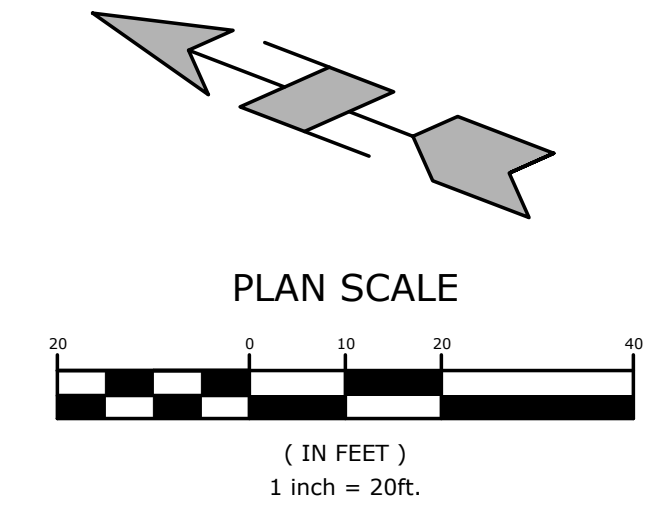
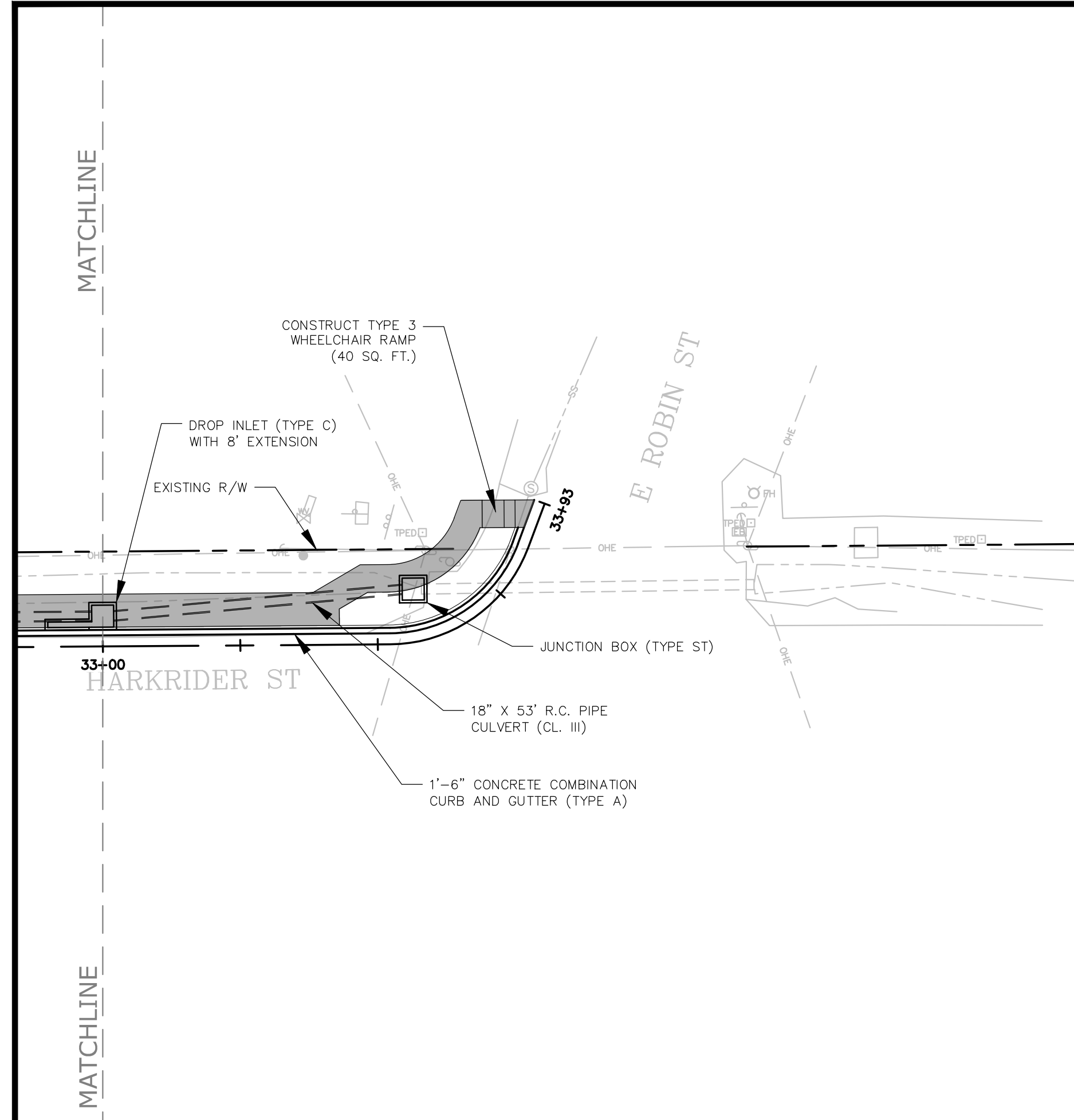

W:\2019\19-5755 Conway Harkrider St. Safe Routes to School Sidewalk\Design Drawings\Civil\19-5755-DESIGN.dwg 5/24/19 at 11:08am