

City Council Members

Mayor Tab Townsell

City Attorney Michael Murphy

City Clerk/Treasurer Michael O. Garrett



Ward 1 Position 1 – Andy Hawkins  
Ward 1 Position 2 – David Grimes  
Ward 2 Position 1 – Mark Vaught  
Ward 2 Position 2 – Shelley Mehl  
Ward 3 Position 1 – Jim Rhodes  
Ward 3 Position 2 – Mary Smith  
Ward 4 Position 1 – Theodore Jones, Jr.  
Ward 4 Position 2 – Shelia Whitmore

---

**City Council Meeting - Tuesday, May 24<sup>th</sup>, 2011 @ 6:30pm**

**Judge Russell L. "Jack" Roberts District Court Building – 810 Parkway St., Conway, AR 72032**

**5:30pm - Committee Meeting:  
Discussion of A&P Ordinances**

---

Call to Order

Roll Call

Minutes: **May 10<sup>th</sup>, 2011**

Announcements / Proclamations / Recognition: **Employee Service Awards**

**1. Report of Standing Committees:**

**A. Economic Development Committee (Airport, Conway Corporation, Conway Development Corporation, Chamber of Commerce & Downtown Partnership)**

1. Resolution adopting the Conway Wastewater Improvement Facilities Plan for Conway Corporation.
2. Ordinance accepting the annexation of certain lands comprise of 57.64 acres located south of Dave Ward Drive and West of Lollie Road and east of Sand Gap Road with the possible addresses of 3605 Lollie Road or 3600 Sand Gap Road.
3. Ordinance to rezone property located South of Dave Ward Drive at 3605 Lollie Road/3600 Sand Gap Road from A-1 to I-3.
4. Consideration of a conditional use permit from the City of Conway for a conditional use permit to allow a new airport for property located south of Dave Ward Drive at 3605 South Lollie Road/3600 Sand Gap Road.
5. Consideration for approval of a material testing contract from Thomas & Associates for the New Conway Airport in the Lollie Bottoms.

**B. Community Development Committee (Planning, Zoning, Permits, Community Development, Historic District, Streets, & Conway Housing Authority)**

1. Consideration to accept the nomination of Geneva Stephens for the Housing Authority Board.
2. Resolution in support of a Safe Routes to School Grant application for sidewalks and traffic calming measures along Siebenmorgan Road, Bill Lucy Drive, Lee Street, Manor Drive and Stermer Road.
3. Resolution in support of a joint-use agreement grant with Conway High School West for the purpose of Laurel Park Tennis Court use and new lighting.
4. Ordinance to rezone property located at 2002 Dave Ward Drive from R-2 to O-3.

5. Ordinance to rezone property located at 605, 615, & 725 Donaghey Ave; 2111 & 2117 Louvenia Ave, 2118 & 2120 Ada Ave; 720 Western Ave; 2229 Robinson Ave and 2135 Caldwell St from R-2A to S-1.
6. Consideration to paint traffic signal poles in Downtown Conway on Oak Street.

**C. Public Safety Committee (Police, CEOC, Information Technology, Fire, District Court, City Attorney & Animal Welfare)**

1. Ordinance appropriating funding for Civil Service expense for the Conway Fire Department promotion testing.
2. Consideration of a request from the Conway Police Department to hold a public hearing to discuss the changes to the Civil Service Rules as related to the hiring and selection process.

**Old Business**

**New Business**

1. Ordinance amending Ordinances O-05-97 & O-05-98 allowing for additional use of taxes collected upon the sale of prepared food and beverages.
2. Ordinance adopting budget adjustments for the Conway Parks Department.
3. Ordinance to decreasing the budget for the Conway Parks Department.
4. Ordinance adopting salary adjustments for the City of Conway employees.

**Adjournment**



**City of Conway, Arkansas  
Ordinance No. O-11-\_\_\_\_\_**

**AN ORDINANCE AMENDING ORDINANCES O-05-97 AND O-05-98, ALLOWING FOR ADDITIONAL USES OF TAXES COLLECTED UPON THE GROSS RECEIPTS FROM THE SALE OF PREPARED FOOD AND BEVERAGES FOR THE BENEFIT OF CONWAY PARK FACILITIES; DECLARING AN EMERGENCY; AND FOR OTHER PURPOSES**

**WHEREAS**, pursuant to Ark. Code Ann. § 26-75-602, cities of the first class may, by ordinance levy a tax upon the gross receipts received by restaurants, cafes, cafeterias, delicatessens, drive-in restaurants, carry-out restaurants, concession stands, convenience stores, grocery store-restaurants, and similar business from the sale of prepared food and beverages for on or off-premises consumption, but not applying to organizations qualified under section 501(c)(3) of the federal Internal Revenue Code; and

**WHEREAS**, pursuant to Ark. Code Ann. § 26-75-606, funds generated by such levy may be used, spent, or pledged by the City of Conway Advertising and Promotion Commission (the "Commission") for construction, reconstruction, repair, maintenance, improvement, equipping, and operation of public recreation facilities including but not limited to facilities constituting city parks; and

**WHEREAS**, ordinances O-05-97 and O-05-98 establish A&P Tax No. 1 and A&P Tax No. 2 respectively; and

**WHEREAS**, there exists a formal agreement between the Commission and the City of Conway that designates the proceeds of such tax levy and stipulating that the funds A&P Tax No. 1 and A&P Tax No. 2 will be deposited into a special fund to be used for the development, purchase, and construction of Conway parks to be disbursed by the Mayor upon approval of the City Council; and

**WHEREAS**, all of the proceeds of the 75% portion of A&P Tax No. 1 designated for city parks and recreation facilities and all of the proceeds of A&P Tax No. 2 are pledged to the payment of the City's 2007 Capital Improvement Bonds and are to be deposited with the bond trustee; and

**WHEREAS**, to the extent these proceeds are not used to pay scheduled debt service, they are released by the trustee back to the City; and

**WHEREAS**, Section 1 of ordinance O-07-54 stipulates "The use of surplus collections of A&P Tax No. 1 and A&P Tax No. 2 will be controlled by the provisions of the Advertising and Promotion Commission Act, Ordinance No. O-05-97, Ordinance No. O-05-98 and the trust indenture governing the issuance of and security for the Park Improvement Bonds and the Trail Improvement Bonds."; and

**WHEREAS**, Section 7 of ordinance O-07-54 stipulates "Conditional upon the approval of Question One and/or Question Two set forth in Section 3 hereof at the June 12, 2007 special election, the levy of A&P Tax No. 2, previously limited to three years under the provisions of Section 1 of Ordinance No. O-05-98, shall be extended to the date of final payment of any park improvement bond or trail improvement bonds."; and

**WHEREAS**, contingent upon the Commission amending its formal agreement with the City of Conway, the new agreement will stipulate that the funds generated may also be used for operation and maintenance of public recreation facilities in the City of Conway.

**NOW, THEREFORE, BE IT ORDAINED BY THE CITY COUNCIL OF THE CITY OF CONWAY, ARKANSAS THAT:**

**Section 1.** Section 1 of ordinance O-05-97 is hereby amended to read as follows: "The City of Conway shall levy a one percent (1.00%) tax upon prepared food and beverages as authorized by state law. Of this levy, twenty five percent (or \$0.25) shall be used at the discretion of the Commission, and seventy five percent (or (\$0.75) shall be used by the Commission at the direction of the Mayor upon approval of the City Council for the development, purchase, construction, operation, and maintenance of the Conway parks and recreation facilities.

**Section 2.** Section 1 of ordinance O-05-98 is hereby amended to read as follows: "The City of Conway shall levy a one percent (1.00%) tax upon prepared food and beverages as authorized by state law for a period of time to expire three years subsequent to the effective date of this ordinance for the development, purchase, construction, operation, and maintenance of Conway parks to be disbursed by the Mayor upon approval of the City Council."

**Section 3.** All ordinances in conflict herewith are repealed to the extent of the conflict.

**PASSED** this 24<sup>th</sup> day of May, 2011.

**Approved:**

---

**Mayor Tab Townsell**

**Attest:**

---

**Michael O. Garrett**  
**City Clerk/Treasurer**

**Sponsor:**

---

**Mark Vaught**  
**Alderman Ward 2, Position 1**



City of Conway, Arkansas  
Ordinance No. O-11-\_\_\_\_

**AN ORDINANCE ADOPTING BUDGET ADJUSTMENTS FOR THE PARKS DEPARTMENT AND PROVIDING THAT THE AMOUNTS STATED HEREIN SHALL BECOME APPROPRIATED FROM THE PROPER ACCOUNTS IN THE CITY; DECLARING AN EMERGENCY; AND FOR OTHER PURPOSES**

**WHEREAS**, at the time of the adoption of the budget for the City of Conway for fiscal year 2011, the operations budget of the Parks Department was funded by the General Fund of the City, and

**WHEREAS**, the City Council has adopted ordinance O-11-\_\_\_\_ authorizing revenue from the Parks Department Special Revenue A&P Account (252-000-5800) to be used for the operation and maintenance of parks and recreational facilities in the City of Conway, and

**WHEREAS**, the City Council desires to amend the Parks Department operation budget for fiscal year 2011 to allow partial funding from the Parks Department Special Revenue A&P Account (252-000-5800).

**NOW, THEREFORE, BE IT ORDAINED BY THE CITY COUNCIL OF THE CITY OF CONWAY, ARKANSAS THAT:**

**Section 1.** The Parks Department operating budget for fiscal year 2011 shall be decreased by an amount of \$250,000.

**Section 2.** The mayor is hereby directed to cause the proper accounting entries to be made in the books and records of the City so as to reflect the amendments to the budget for the aforesaid fiscal year.

**Section 3.** All ordinances in conflict herewith are repealed to the extent of the conflict.

**PASSED** this 24th day of May, 2011.

**Approved:**

\_\_\_\_\_  
**Mayor Tab Townsell**

**Attest:**

\_\_\_\_\_  
**Michael O. Garrett**  
City Clerk/Treasurer



City of Conway, Arkansas  
Ordinance No. O-11-\_\_\_\_\_

**AN ORDINANCE ADOPTING BUDGET ADJUSTMENTS FOR THE PARKS DEPARTMENT AND PROVIDING THAT THE AMOUNTS STATED HEREIN SHALL BECOME APPROPRIATED FROM THE PROPER ACCOUNTS IN THE CITY; DECLARING AN EMERGENCY; AND FOR OTHER PURPOSES**

**WHEREAS**, at the time of the adoption of the budget for the City of Conway for fiscal year 2011, the operations budget of the Parks Department was funded by the General Fund of the City, and

**WHEREAS**, the City Council has adopted ordinance O-11-\_\_\_\_ authorizing revenue from the Parks Department Special Revenue A&P Account (252-000-5800) to be used for the operation and maintenance of parks and recreational facilities in the City of Conway, and

**WHEREAS**, the City Council desires to amend the Parks Department operation budget for fiscal year 2011 to allow partial funding from the Parks Department Special Revenue A&P Account (252-000-5800).

**NOW, THEREFORE, BE IT ORDAINED BY THE CITY COUNCIL OF THE CITY OF CONWAY, ARKANSAS THAT:**

**Section 1.** The Parks Department operating budget for fiscal year 2011 shall be increased by an amount of \$250,000, the funding of which shall be appropriated from the Parks Department Special Revenue A&P Account (252-000-5800).

**Section 2.** The mayor is hereby directed to cause the proper accounting entries to be made in the books and records of the City so as to reflect the amendments to the budget for the aforesaid fiscal year.

**Section 3.** All ordinances in conflict herewith are repealed to the extent of the conflict.

**PASSED** this 24th day of May, 2011.

**Approved:**

\_\_\_\_\_  
**Mayor Tab Townsell**

**Attest:**

\_\_\_\_\_  
**Michael O. Garrett**  
City Clerk/Treasurer



City of Conway, Arkansas  
Ordinance No. O-11-\_\_\_\_\_

**AN ORDINANCE ADOPTING SALARY ADJUSTMENTS FOR CITY EMPLOYEES; DECLARING AN EMERGENCY; AND FOR OTHER PURPOSES**

**WHEREAS**, part of the agreement of employment for the employees of the City of Conway are certain step increases in salaries over a period of time, and

**WHEREAS**, budgetary problems within the General Fund of the City have prevented employees eligible to receive step increases for as many as two years prior, and

**WHEREAS**, there now exists additional revenue in the General Fund of the City to fund one step increase for eligible employees for the remainder of 2011.

**NOW, THEREFORE, BE IT ORDAINED BY THE CITY COUNCIL OF THE CITY OF CONWAY, ARKANSAS THAT:**

**Section 1.** Effective June 1, 2011, all employees of the City of Conway eligible to receive step increases shall have their salaries increased to the proper amount equal to one step increase.

**Section 2.** The mayor is hereby directed to cause the proper accounting entries to be made in the books and records of the City so as to reflect the amendments to the budget for the aforesaid fiscal year.

**Section 3.** All ordinances in conflict herewith are repealed to the extent of the conflict.

**PASSED** this 24th day of May, 2011.

**Approved:**

\_\_\_\_\_  
**Mayor Tab Townsell**

**Attest:**

\_\_\_\_\_  
**Michael O. Garrett**  
City Clerk/Treasurer

**Sponsor:**

\_\_\_\_\_  
**Mark Vaught**  
Alderman Ward 2, Position 1



**City of Conway, Arkansas  
Resolution No. R-11-\_\_\_**

**A RESOLUTION ADOPTING THE CONWAY WASTEWATER IMPROVEMENTS FACILITIES PLAN**

**WHEREAS**, Conway Corporation operates the wastewater treatment plants and collection system for the City of Conway; and

**WHEREAS**, as a condition of financing the proposed Tupelo Bayou Wastewater Treatment Plant, the Arkansas Natural Resources Commission requires the adoption of a Facilities Plan by the City; and

**WHEREAS**, Conway Corporation's Board of Directors has reviewed and recommend adoption of the Facilities Plan.

**NOW, THEREFORE, BE IT RESOLVED** by the City Council of the City of Conway, Arkansas that the Wastewater Improvements Facilities Plan is approved by the City Council.

**ADOPTED on this 24<sup>th</sup> day of May, 2011**

**Approved:**

---

**Mayor Tab Townsell**

**Attest:**

---

**Michael O. Garrett  
City Clerk/Treasurer**



## **CONWAY WASTEWATER IMPROVEMENTS FACILITY PLAN**

### ***Executive Summary***

Conway Corporation has entered into a Memorandum of Agreement with the Arkansas Natural Resources Commission (ANRC) to procure funds necessary to complete the Conway Corporation Wastewater System Improvements Project. One of the ANRC requirements is that the City Council approve a resolution adopting the final Facility Plan. This executive summary is provided to help facilitate the required approval. A copy of the entire final Facility Plan will be made available upon request.

The Clean Water Revolving Loan Fund (CWRLF) program initially requires that a Facility Plan be prepared to examine existing and future needs, summarize possible alternatives investigated along with their associated costs, and provide a recommendation for the best alternative to meet those needs. Public participation was also included with a Public Meeting and Public Hearing held to discuss the Facility Plan report. Conway Corporation has been investigating the infrastructure needs of the community beginning with the preparation of a Wastewater Master Plan document in 2007. The Master Planning efforts included a comprehensive evaluation of Conway's wastewater collection system and treatment facilities. Based on this evaluation, facilities needed to serve the community through the year 2030 were recommended. Recommendations in the Master Plan included the construction of the improvements included in this project.

This project includes construction of a new wastewater treatment plant, collection lines, and pump stations with corresponding force mains. The project identification by the ANRC CWRLF program is Agreement No. 00747-CWRLF-L, and Project No. WRD-003-694. Conway Corporation will be responsible for the operation, management, and maintenance of the project improvements.

One of the determining factors for the necessity of the proposed improvement was the restrictions of the existing Stone Dam Wastewater Treatment Plant (SDWWTP) and the Tucker Creek Wastewater Treatment Plant (TCWWTP). The original SDWWTP was constructed in 1928 and reconstructed adjacent to the original plant in 1979. New regulations governing the quality of the water discharged from the plant would require significant additional improvements. TCWWTP was constructed in 1996. This aerated pond type of treatment is commonly associated with operational difficulties and odor nuisances. Both WWTP's are operating close to treatment capacity. It was determined the most economically feasible option is to decommission the SDWWTP, construct a new WWTP (Tupelo Bayou WWTP) on the southwest side of Conway that will discharge to the Arkansas River, and eventually convert the TCWWTP from treatment to equalization. Collection system improvements would be necessary to convey the wastewater to the proposed Tupelo Bayou Wastewater Treatment Plant (TBWWTP) from the SDWWTP location. The conveyance system improvements would include construction of approximately 18,500 LF of 36-inch diameter force main, 19,500 LF of 48-inch diameter gravity main, and the construction of new pump stations. The TBWWTP will be initially constructed to treat 8 or 16 million gallons per day (MGD) and be expandable to meet future needs up to 32 MGD with the construction of additional facilities.

The Facility Plan has been prepared and submitted to ANRC and other state and federal regulatory agencies for review and comment. Currently, all comments have been addressed and appropriate revisions made to the Facility Plan. One of the requirements of the CWRLF includes the City Council approval of a resolution adopting the final Facility Plan.



**City of Conway, Arkansas**  
**Ordinance No. O-11- \_\_\_\_\_**

**AN ORDINANCE ACCEPTING THE ANNEXATION OF CERTAIN LANDS COMPRISED OF 57.64 ACRES LOCATED SOUTH OF DAVE WARD DRIVE AND WEST OF LOLLIE ROAD AND EAST OF SAND GAP ROAD WITH THE POSSIBLE ADDRESSES OF 3605 LOLLIE ROAD OR 3600 SAND GAP ROAD TO THE CITY OF CONWAY, ARKANSAS; DECLARING AN EMERGENCY; AND FOR OTHER PURPOSES:**

**NOW, THEREFORE, BE IT ORDAINED BY THE CITY COUNCIL OF THE CITY OF CONWAY, ARKANSAS:**

**SECTION 1:** That the City of Conway, Arkansas, hereby accepts the hereinafter described territory, annexed to said City by order of the County Court of Faulkner County, Arkansas, heretofore entered on the 17<sup>th</sup> day of **May, 2011**, and said territory being situated in Faulkner County, Arkansas, shall be a part of the City of Conway and shall be zoned I-3 and described as follows:

A part of the E ½ SE ¼ of Section 2, T-4-2-N, R-15-W, described as beginning at a found ½" rebar at the NE Corner of said E ½ SE ¼ thence along East line of said Section 2, S 01-37-29 W 1220.67 ft to a ½" rebar; thence leaving said East line S 45-04-03 W 1706.20 ft to a set ½" rebar; thence N 44-55-57 W 202.17 ft to a set ½" rebar on the West line of said E ½ SE ¼; thence along said West line N 01-37-30 E 2322.17 feet to a to a set ½" rebar at the NW corner of the NE ¼ SE ¼; thence along the North line of said NE ¼ SE ¼ 130.01 ft to the point of beginning containing 39.96 acres in the NE ¼ SE ¼ and 17.68 acres in the SE ¼ SE ¼, making a total of 57.64 acres more or less.

and that above said – described lands and territory be, and the same hereby are, declared to be a part of the City of Conway, Faulkner County, Arkansas.

**SECTION 2:** That unless a street is specifically named in this ordinance as being accepted for maintenance or to provide street frontage for the issuance of building permits, it shall not be accepted for either purpose.

**SECTION 3:** From and after this date, the inhabitants residing within and upon the hereinabove described lands and territory shall have and enjoy all the rights and privileges of, and be subject to all the laws, rules, ordinances, limitations and regulations imposed upon the inhabitants within the original limits of said City of Conway, Arkansas, and for voting purposes, said lands are hereby assigned to and designated as a part of **Ward 1** of the City of Conway, Arkansas.

**SECTION 4:** It is hereby ascertained and declared that it is necessary for the protection and preservation of the public health and safety that the foregoing ordinance shall take effect and be in force from and after its passage and publication.

**PASSED** this 24<sup>th</sup> day of **May, 2011**.

**APPROVED:**

\_\_\_\_\_  
**Mayor Tab Townsell**

**ATTEST:**

\_\_\_\_\_  
**Michael O. Garrett**  
**City Clerk/Treasurer**

# CITY OF CONWAY

## CONWAY AIRPORT ANNEXATION

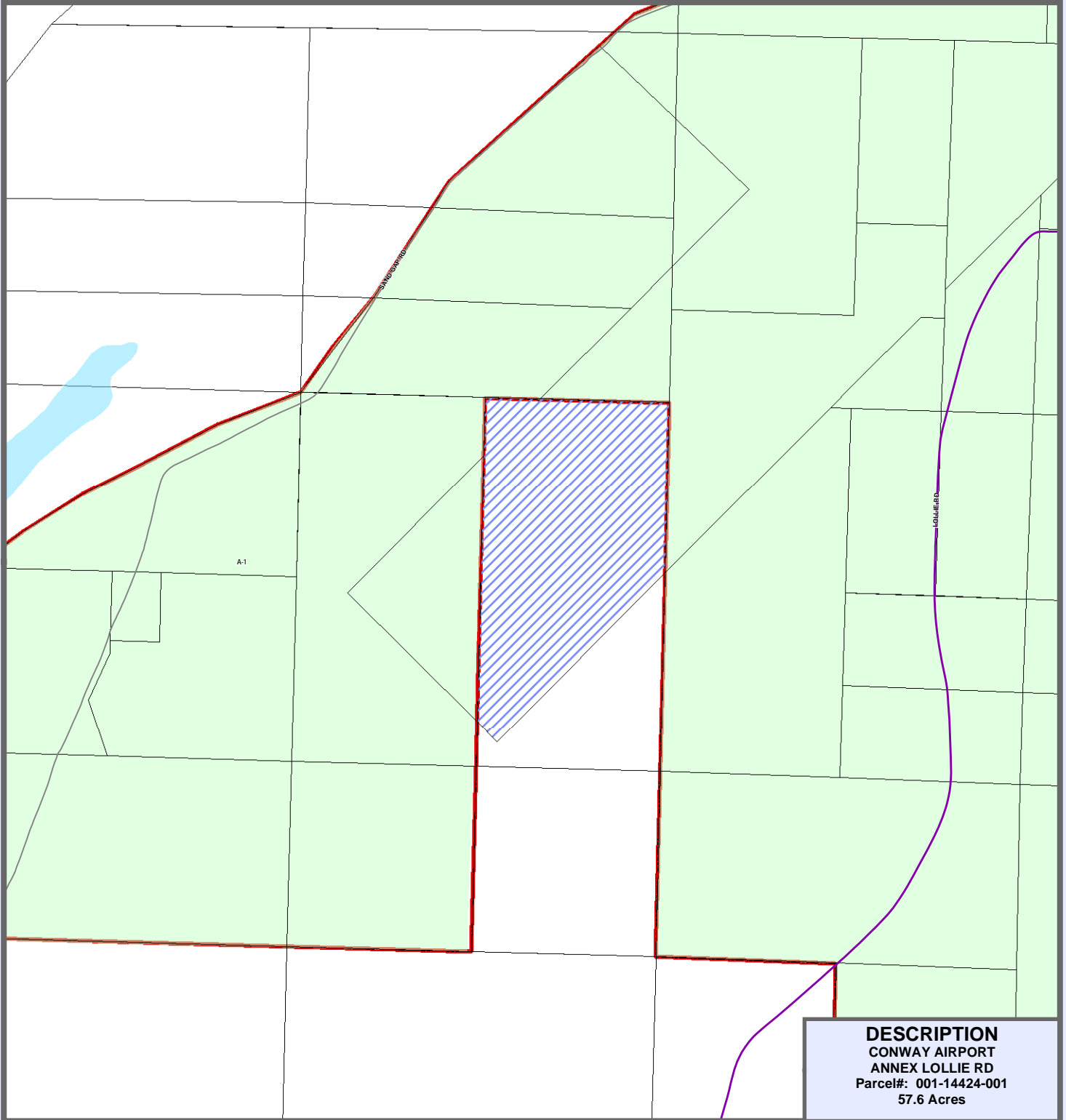

**DESCRIPTION**  
**CONWAY AIRPORT**  
**ANNEX LOLLIE RD**  
**Parcel#: 001-14424-001**  
**57.6 Acres**

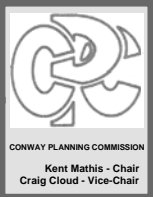
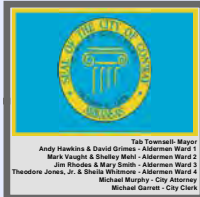

INTERSTATE	LOT LINE	<b>Residential</b>	<b>Industrial</b>
MAJOR ARTERIAL	STREAMS	R-1	MF-1
MINOR ARTERIAL	LAKES & PONDS	R-2A	MF-2
COLLECTOR	CITY LIMITS	R-2	MF-3
RESIDENTIAL		HR	RMH
PRIVATE ROAD		SR	
INTERSTATE RAMP		<b>Commercial</b>	<b>Office</b>
RAILROADS		C-1	O-1
		C-2	O-2
		C-3	O-3
		C-4	<b>Special</b>
			SP
			S-1
			A-1
			PUD

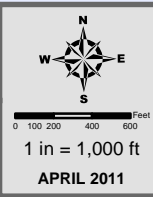

THIS MAP WAS PREPARED BY THE CITY OF CONWAY PLANNING AND DEVELOPMENT DEPARTMENT FOR ITS USE AND MAY BE REVISED AT ANY TIME WITHOUT NOTIFICATION TO ANY USER. THE CITY OF CONWAY PLANNING AND DEVELOPMENT DEPARTMENT DOES NOT GUARANTEE THE CORRECTNESS OR ACCURACY OF ANY FEATURES ON THIS MAP. CITY OF CONWAY ASSUMES NO RESPONSIBILITY IN CONNECTION THEREWITH.

CONTACT INFORMATION  
 LANDMARK GIS WEBSITE:  
 gis.cityofconway.org (UNDER DEVELOPMENT)  
 E-MAIL: Jason.Lyon@CityOfConway.org



**City of Conway, Arkansas**  
**Ordinance No. O-11- \_\_\_\_\_**

**AN ORDINANCE AMENDING SECTIONS 201.1 AND 201.3 OF THE CONWAY ZONING ORDINANCE TO REZONE PROPERTY LOCATED SOUTH OF DAVE WARD DR AT 3605 LOLLIE ROAD/3600 SAND GAP ROAD FROM A-1 TO I-3:**

**NOW, THEREFORE, BE IT ORDAINED BY THE CITY COUNCIL OF THE CITY OF CONWAY, ARKANSAS THAT:**

**SECTION 1:** The Zoning District Boundary Map of the Conway Land Development Code be amended by changing all the **A-1** symbols and indications as shown on the Zoning District Boundary Map in an area described as follows:

Beginning at a found ½" rebar at the SW corner of the SE ¼ SE ¼ of Section 36; thence along the west line of the E ½ of the SE ¼ N01-33-45E 2643.61 to a found 2" pipe at the SW corner of said SE ¼ NE ¼, said point being the point of beginning; thence leaving said west line N46-47-10E 928.85 feet; thence S88-00-44E 660.00 feet to the east line of said SE ¼ NE ¼; thence along said east line S01-28-28W 660.00 feet to the SE corner of the SE ¼ NE ¼; thence leaving said SE corner S01-37-44W 892.75 feet; thence S45-04-03W 1960.01 feet to the east line of said SW ¼ SE ¼; thence along said east line S01-33-45W 318.43 feet; thence along the south line of the SW ¼ SE ¼, Section 36, T-5-N, R-15-W, N87-54-05W 299.59 feet; thence S45-04-03W 2441.49 feet; thence continuing S45-04-03W 282.95 feet; thence continuing S45-04-03W 2594.46 feet a point on the west line of Section 1; thence along said west line N01-37-29E 1220.67 feet to a point at the NW corner of the NW ¼ SW ¼ of Section 1; thence along the south line of said SE ¼ NE ¼ Section 2 N88-18-04W 922.53 feet; thence leaving said south line N45-04-03E 917.47 feet; thence continuing N45-04-03E 1192.29 feet; thence N44-55-57W 1473.44 feet; thence N48-50-49E 336.58 feet; thence N68-51-34E 1053.86 feet; N41-07-16E 632.97 feet; thence S44-55-57E 730.68 feet; thence N45-04-03E 2913.91 feet; thence S88-02-42E 340.13 feet to the point of beginning. 374.02 Acres more or less.

**Also:**

Part of the W ½ SE ¼ of Section 2, T-4-N, R-15-W, Faulkner County Arkansas; more particularly described as beginning at the NE corner of Section 2, T-4-N, R-15-W; thence along the east line of said Section 2, S01-37-29W 2645.33 feet to the NE corner of the NE ¼ SE ¼; thence leaving said east line N88-18-04W 1320.01 feet to the NE corner of the NW ¼ SE ¼; thence along the east line of said W ½ SE ¼ S01-37-30W 420.22 feet to the point of beginning; thence continue along said east line S01-37-30W 1901.95 feet; thence leaving said east line N44-55-57W 1307.83 feet; thence N45-04-03E 1380.94 feet to the point of beginning. 20.73 acres more or less.

to those of **I-3**, and a corresponding use district is hereby established in the area above described and said property is hereby rezoned.

**SECTION 2:** All ordinances in conflict herewith are repealed to the extent of the conflict.

**PASSED** this 24<sup>th</sup> day of May, 2011.

**Approved:**

\_\_\_\_\_  
**Mayor Tab Townsell**

**Attest:**

\_\_\_\_\_  
**Michael O. Garrett**  
**City Clerk/Treasurer**



## CONWAY PLANNING COMMISSION

1201 OAK STREET CONWAY, AR 72032 (501) 450-6105

May 17, 2011

Council Members  
Conway, AR 72032

Dear Council Members:

City of Conway request for a rezoning from A-1 to I-3 for property located south of Dave Ward Drive at 3605 Lollie Road/3600 Sand Gap Road with the legal description:

Beginning at a found ½" rebar at the SW corner of the SE ¼ SE ¼ of Section 36; thence along the west line of the E ½ of the SE ¼ N01-33-45E 2643.61 to a found 2" pipe at the SW corner of said SE ¼ NE ¼, said point being the point of beginning; thence leaving said west line N46-47-10E 928.85 feet; thence S88-00-44E 660.00 feet to the east line of said SE ¼ NE ¼; thence along said east line S01-28-28W 660.00 feet to the SE corner of the SE ¼ NE ¼; thence leaving said SE corner S01-37-44W 892.75 feet; thence S45-04-03W 1960.01 feet to the east line of said SW ¼ SE ¼; thence along said east line S01-33-45W 318.43 feet; thence along the south line of the SW ¼ SE ¼, Section 36, T-5-N, R-15-W, N87-54-05W 299.59 feet; thence S45-04-03W 2441.49 feet; thence continuing S45-04-03W 282.95 feet; thence continuing S45-04-03W 2594.46 feet a point on the west line of Section 1; thence along said west line N01-37-29E 1220.67 feet to a point at the NW corner of the NW ¼ SW ¼ of Section 1; thence along the south line of said SE ¼ NE ¼ Section 2 N88-18-04W 922.53 feet; thence leaving said south line N45-04-03E 917.47 feet; thence continuing N45-04-03E 1192.29 feet; thence N44-55-57W 1473.44 feet; thence N48-50-49E 336.58 feet; thence N68-51-34E 1053.86 feet; N41-07-16E 632.97 feet; thence S44-55-57E 730.68 feet; thence N45-04-03E 2913.91 feet; thence S88-02-42E 340.13 feet to the point of beginning. 374.02 Acres more or less.

Also:

Part of the W ½ SE ¼ of Section 2, T-4-N, R-15-W, Faulkner County Arkansas; more particularly described as beginning at the NE corner of Section 2, T-4-N, R-15-W; thence along the east line of said Section 2, S01-37-29W 2645.33 feet to the NE corner of the NE ¼ SE ¼; thence leaving said east line N88-18-04W 1320.01 feet to the NE corner of the NW ¼ SE ¼; thence along the east line of said W ½ SE ¼ S01-37-30W 420.22 feet to the point of beginning; thence continue along said east line S01-37-30W 1901.95 feet; thence leaving said east line N44-55-57W 1307.83 feet; thence N45-04-03E 1380.94 feet to the point of beginning. 20.73 acres more or less.

was reviewed by the Planning Commission at its regular meeting on May 16, 2011. The Planning Commission voted 6 – 0 that the request be sent to the City Council with a recommendation for approval.

Submitted by,

Kent Mathis, Chairman  
Planning Commission

# CITY OF CONWAY

## CONWAY AIRPORT REZONE A-1 TO I-3

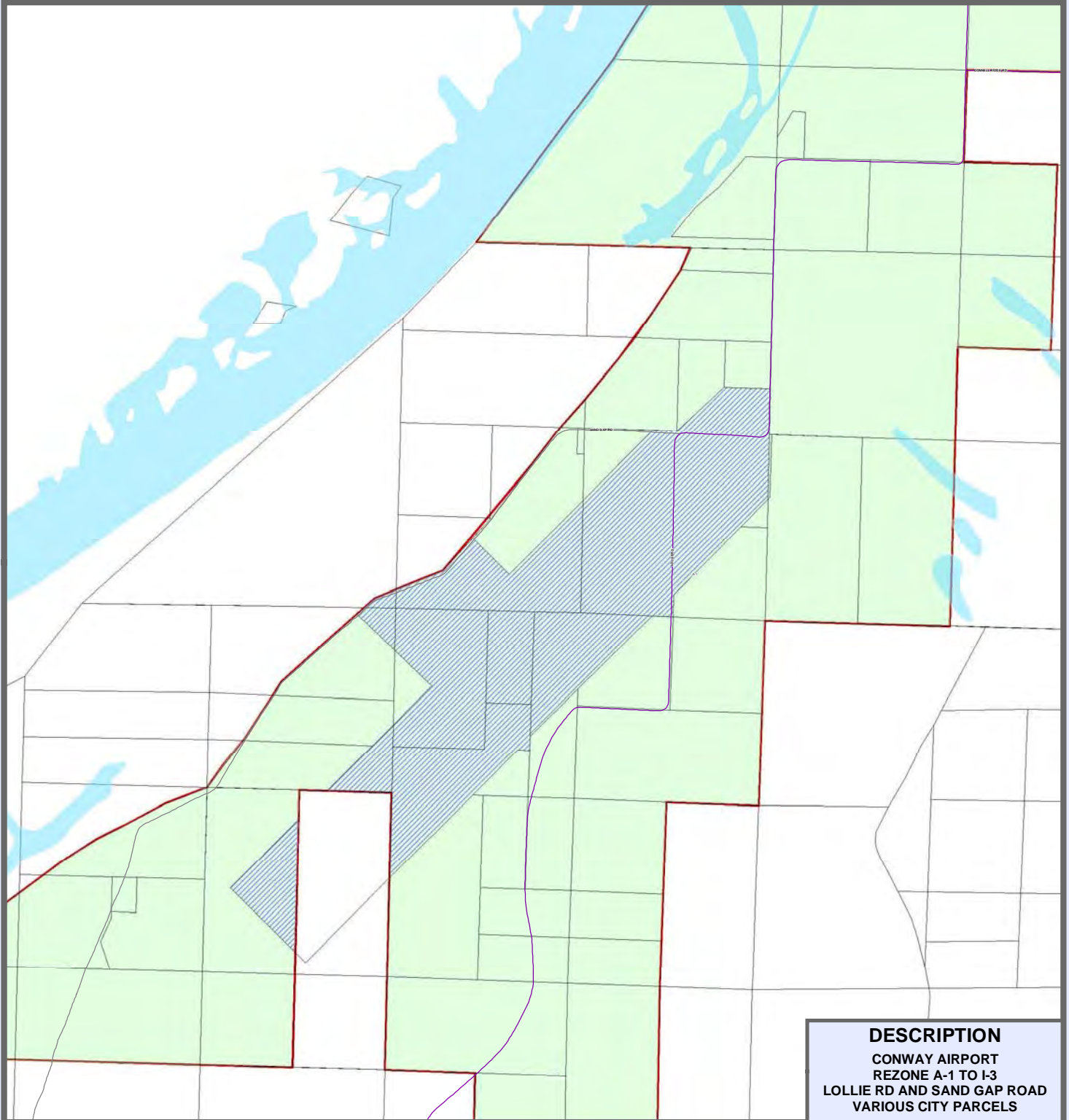

**DESCRIPTION**  
**CONWAY AIRPORT**  
**REZONE A-1 TO I-3**  
**LOLLIE RD AND SAND GAP ROAD**  
**VARIOUS CITY PARCELS**

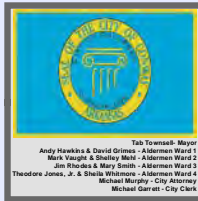

— INTERSTATE	— LOT LINE
— MAJOR ARTERIAL	— STREAMS
— MINOR ARTERIAL	— LAKES & PONDS
— COLLECTOR	— CITY LIMITS
— RESIDENTIAL	
— PRIVATE ROAD	
— INTERSTATE RAMP	
— RAILROADS	

Residential		Industrial	
R-1	MF-1	I-1	
R-2A	MF-2	RU-1	
R-2	MF-3	I-3	
HR	RMH		
SR			
Commercial		Office	
C-1	O-1	SP	
C-2	O-2	S-1	
C-3	O-3	A-1	
C-4		PUD	

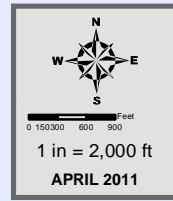

THIS MAP WAS PREPARED BY THE CITY OF CONWAY PLANNING AND DEVELOPMENT DEPARTMENT FOR ITS USE, AND MAY BE REVISED AT ANY TIME WITHOUT NOTIFICATION TO ANY USER. THE CITY OF CONWAY PLANNING AND DEVELOPMENT DEPARTMENT DOES NOT GUARANTEE THE CORRECTNESS OR ACCURACY OF ANY FEATURES ON THIS MAP. CITY OF CONWAY ASSUMES NO RESPONSIBILITY IN CONNECTION THEREWITH.

CONTACT INFORMATION  
 LANDMARK THIS WEBSITE  
[gis.cityofconway.org](http://gis.cityofconway.org) (UNDER DEVELOPMENT)  
 E-MAIL: Jason.Lyon@CityOfConway.org



## CONWAY PLANNING COMMISSION

1201 OAK STREET CONWAY, AR 72032 (501) 450-6105

May 17, 2011

Council Members  
Conway, AR 72032

Dear Council Members:

City of Conway request for a conditional use permit to allow a new airport for property located south of Dave Ward Drive at 3605 Lollie Road/3600 Sand Gap Road with the legal description:

Beginning at a found ½" rebar at the SW corner of the SE ¼ SE ¼ of Section 36; thence along the west line of the E ½ of the SE ¼ N01-33-45E 2643.61 to a found 2" pipe at the SW corner of said SE ¼ NE ¼, said point being the point of beginning; thence leaving said west line N46-47-10E 928.85 feet; thence S88-00-44E 660.00 feet to the east line of said SE ¼ NE ¼; thence along said east line S01-28-28W 660.00 feet to the SE corner of the SE ¼ NE ¼; thence leaving said SE corner S01-37-44W 892.75 feet; thence S45-04-03W 1960.01 feet to the east line of said SW ¼ SE ¼; thence along said east line S01-33-45W 318.43 feet; thence along the south line of the SW ¼ SE ¼, Section 36, T-5-N, R-15-W, N87-54-05W 299.59 feet; thence S45-04-03W 2441.49 feet; thence continuing S45-04-03W 282.95 feet; thence continuing S45-04-03W 2594.46 feet a point on the west line of Section 1; thence along said west line N01-37-29E 1220.67 feet to a point at the NW corner of the NW ¼ SW ¼ of Section 1; thence along the south line of said SE ¼ NE ¼ Section 2 N88-18-04W 922.53 feet; thence leaving said south line N45-04-03E 917.47 feet; thence continuing N45-04-03E 1192.29 feet; thence N44-55-57W 1473.44 feet; thence N48-50-49E 336.58 feet; thence N68-51-34E 1053.86 feet; N41-07-16E 632.97 feet; thence S44-55-57E 730.68 feet; thence N45-04-03E 2913.91 feet; thence S88-02-42E 340.13 feet to the point of beginning. 374.02 Acres more or less.

Also:

Part of the W ½ SE ¼ of Section 2, T-4-N, R-15-W, Faulkner County Arkansas; more particularly described as beginning at the NE corner of Section 2, T-4-N, R-15-W; thence along the east line of said Section 2, S01-37-29W 2645.33 feet to the NE corner of the NE ¼ SE ¼; thence leaving said east line N88-18-04W 1320.01 feet to the NE corner of the NW ¼ SE ¼; thence along the east line of said W ½ SE ¼ S01-37-30W 420.22 feet to the point of beginning; thence continue along said east line S01-37-30W 1901.95 feet; thence leaving said east line N44-55-57W 1307.83 feet; thence N45-04-03E 1380.94 feet to the point of beginning. 20.73 acres more or less.

Also:

A part of the E ½ SE ¼ of Section 2, T-4-2-N, R-15-W, described as beginning at a found ½" rebar at the NE Corner of said E ½ SE ¼ thence along East line of said Section 2, S01-37-29W 1220.67 feet to a ½" rebar; thence leaving said East line S45-04-03W 1706.20 feet to a set ½" rebar; thence N44-55-57W 202.17 feet to a set ½" rebar on the West line of said E ½ SE ¼; thence along said West line N01-37-30E 2322.17 feet to a set ½" rebar at the NW corner of the NE ¼ SE ¼; thence along the North line of said NE ¼ SE ¼ 130.01 feet to the point of beginning containing 39.96 acres in the NE ¼ SE ¼ and 17.68 acres in the SE ¼ SE ¼, making a total of 57.64 acres more or less.

was reviewed by the Planning Commission at its regular meeting on May 16, 2011. The Planning Commission voted 6 – 0 that the request be sent to the City Council with a recommendation for approval without conditions attached.

Submitted by,

Kent Mathis, Chairman  
Planning Commission

# CITY OF CONWAY

## CONWAY AIRPORT CONDITIONAL USE

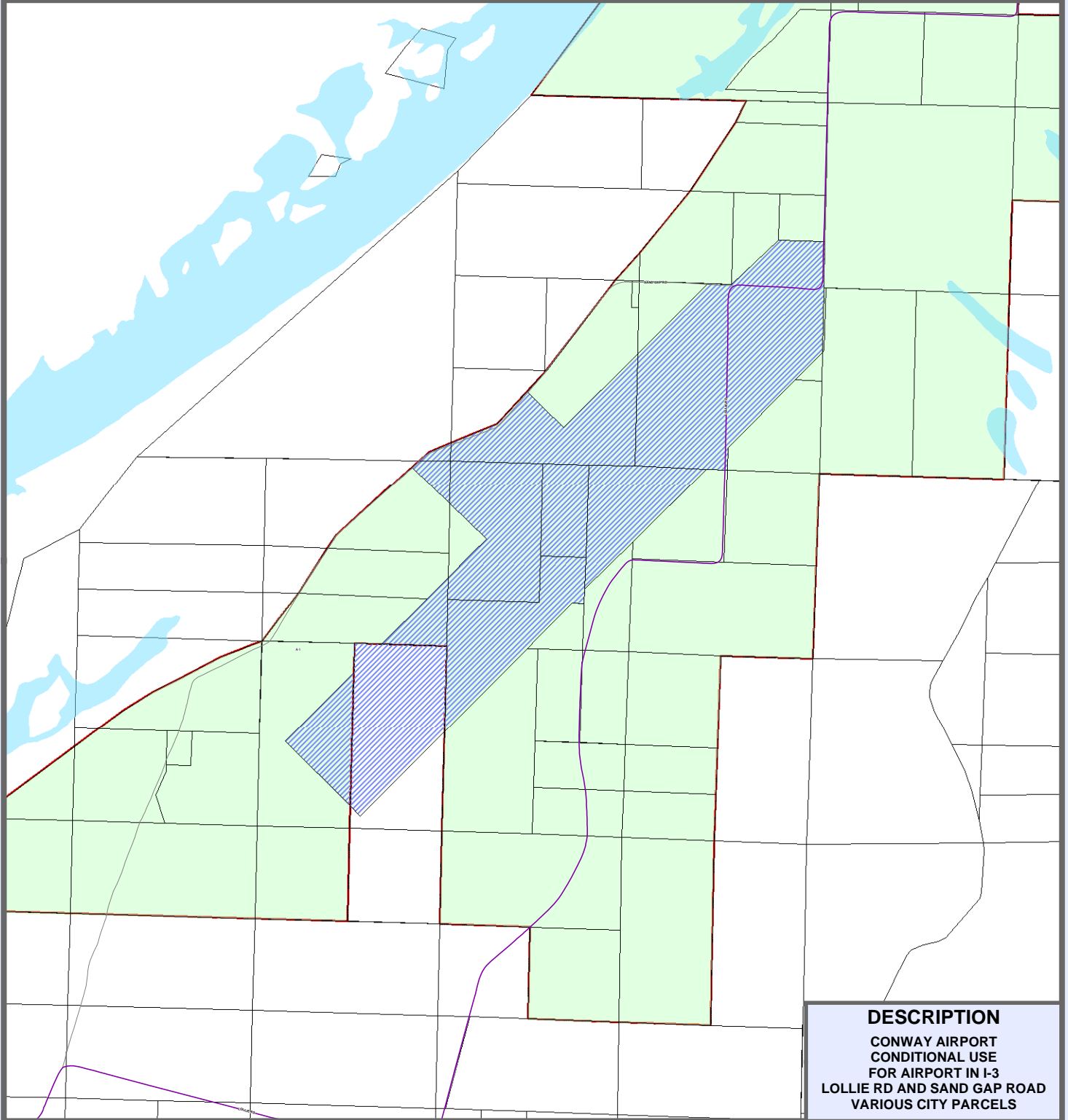

**DESCRIPTION**  
**CONWAY AIRPORT**  
**CONDITIONAL USE**  
**FOR AIRPORT IN I-3**  
**LOLLIE RD AND SAND GAP ROAD**  
**VARIOUS CITY PARCELS**

Tab Townsell - Mayor  
 Andy Hawkins & David Grimes - Aldermen Ward 1  
 Mark Vaughn & Shelby Mahl - Aldermen Ward 2  
 Jim Rhodes & Mary Smith - Aldermen Ward 3  
 Theodore Jones, Jr. & Sheila Whitmore - Aldermen Ward 4  
 Michael Murphy - City Attorney  
 Michael Garrett - City Clerk

Bryan Patrick - Director  
 Donald Anthony - Deputy Director  
 Wes Craiglow - Deputy Director  
 Christy Sutherland - Planner  
 Liletha Rhee - Planning Tech  
 Jason Lyon - GIS Coordinator

**CONWAY PLANNING COMMISSION**  
 Kent Mathis - Chair  
 Craig Cloud - Vice-Chair

<ul style="list-style-type: none"> <li>— INTERSTATE</li> <li>— MAJOR ARTERIAL</li> <li>— MINOR ARTERIAL</li> <li>— COLLECTOR</li> <li>— RESIDENTIAL</li> <li>— PRIVATE ROAD</li> <li>— INTERSTATE RAMP</li> <li>— RAILROADS</li> </ul>	<ul style="list-style-type: none"> <li>— LOT LINE</li> <li>— STREAMS</li> <li>— LAKES &amp; PONDS</li> <li>— CITY LIMITS</li> </ul>
--	---

<b>Residential</b> R-1 R-2A R-2 HR SR	<b>Industrial</b> MF-1 MF-2 MF-3 RMH	<b>Commercial Office</b> C-1 C-2 C-3 C-4	<b>Industrial</b> I-1 RU-1 I-3	<b>Special</b> SP S-1 A-1 PUD TJ
--	--	--	---	---

0 150300 600 900 Feet  
 1 in = 2,000 ft  
**MAY 2011**

THIS MAP WAS PREPARED BY THE CITY OF CONWAY PLANNING AND DEVELOPMENT DEPARTMENT FOR ITS USE, AND MAY BE REVISED AT ANY TIME WITHOUT NOTIFICATION TO ANY USER. THE CITY OF CONWAY PLANNING AND DEVELOPMENT DEPARTMENT DOES NOT GUARANTEE THE CORRECTNESS OR ACCURACY OF ANY FEATURES ON THIS MAP. CITY OF CONWAY ASSUMES NO RESPONSIBILITY IN CONNECTION THEREWITH.

**CONTACT INFORMATION**  
 LANDMARK GIS WEBSITE:  
 gis.cityofconway.org (UNDER DEVELOPMENT)  
 E-MAIL: Jason.Lyon@CityOfConway.org



**MEMORANDUM**

TO: MAYOR TAB TOWNSELL

FROM: RONNIE HALL, P.E.

DATE: May 19, 2011

REFERENCE: Material Testing Contract  
Lollie Bottoms Airport  
Stage 1A – Grading and Drainage Construction

I have attached a proposed material testing contract from Thomas & Associates, Inc. for the initial earthwork construction project for the Relocated Conway Airport in the Lollie Bottoms. Thomas was included as part of the Garver Team during the consultant selection process. This firm is recommended by our consultant, Garver, to continue work on the airport project. This firm is also a DBE firm thus fulfilling some of our project DBE goals. As shown the estimated cost of this work is \$29,996.00. The charges will be based on the actual testing work performed multiplied by the unit prices in the contract.

I am requesting approval of this contract.

This contract amount will be reimbursed 95% from the 2010 FAA Grant and 5% from a State Aeronautic Department Grant.

# **CONSTRUCTION MANAGEMENT PROGRAM**

**PREPARED FOR THE**

**CONWAY MUNICIPAL AIRPORT  
CONWAY, ARKANSAS**

**STAGE 1A – Grading and Drainage Construction**

**AIP PROJECT NO. 3-05-0089-003-2010**

**Prepared by:**



**April, 2011**

**10011500**

**TABLE OF CONTENTS**

I.	INTRODUCTION	1
II.	PROJECT CONTACTS	2
III.	CONSTRUCTION OBSERVATION	2
IV.	CONSTRUCTION MATERIALS QUALITY ASSURANCE TESTING	4

**APPENDICES**

- APPENDIX A ENGINEERING SUPERVISION AND CONSTRUCTION OBSERVATION QUALIFICATIONS
- APPENDIX B QA TESTING FIRM CONTRACT AND QUALIFICATIONS
- APPENDIX C MATERIAL TESTING REPORT FORM (EXAMPLE)
- APPENDIX D FAA FORM 5370-1 CONSTRUCTION PROGRESS AND INSPECTION REPORT (EXAMPLE)

## I. INTRODUCTION

This program serves as a guide for the quality management of the construction phase of the airport improvements outlined in the Contract Documents for Airport Improvement Program Project 3-05-0089-003-2010. The construction project for which this testing shall be conducted includes the construction of approximately 200,000 cubic yards of earthwork and 140 acres of seeding.

The Testing Firm will be awarded the testing schedule which corresponds to the construction project schedule awarded to the Contractor. The Sponsor will conduct quality assurance operations via engineering supervision, construction observation, and materials testing in accordance with FAA Advisory Circular 150/5370-12 "Quality Control of Construction". The Contractor will provide quality control operations. The Sponsor is the CITY OF CONWAY, ARKANSAS, the Engineer is Garver, LLC., the QA Testing Firm is THOMAS & ASSOCIATES, INC., and the Contractor is A.G. Hunt Construction Co, Inc.

The Engineer will provide construction observation and engineering supervision while the QA Testing Firm will conduct materials testing for acceptance and quality assurance. The Engineering supervision and construction observation qualifications are included in Appendix A. The Sponsor's contracts with the QA Testing Firm are included in Appendices B. The technical specifications containing construction materials that require quality control testing include:

SS-222	Access Road Construction
P-152	Excavation and Embankment
P-610	Structural Portland Cement Concrete

**II. PROJECT CONTACTS**

<b>ROLE</b>	<b>COMPANY</b>	<b>PERSON</b>	<b>CONTACT INFORMATION</b>
Construction Supervisor	TBD	TBD	TBD
Project Manager	Garver, LLC	Blake Roberson, PE	(501) 352-8884 BWRoberson@GarverUSA.com
Construction Observer	Garver, LLC	Jim Ward	(501) 352-8882 JWWard@GarverUSA.com
QA Testing Firm Supervisor	Thomas & Associates, Inc.	Enice Thomas, Jr.	(501) 960-7802 enicetj@aol.com

**III. CONSTRUCTION OBSERVATION**

The Engineer will provide the required construction observation for the construction phase of the project with engineering supervision and field personnel that are qualified to observe the work described in the Contract Documents. Qualifications of the engineering supervision and construction observation personnel are included in Appendix A.

Construction observers shall be fully qualified to make interpretations, decisions, and field computations and have knowledge of the testing requirements and procedures contained in the specifications. The construction observer shall have the authority to reject unsatisfactory workmanship and materials that are not in conformance with the specifications. The construction observer’s primary duties are as follows:

1. Checks activities to ensure compliance with the plans and specifications. Informs the contractor of any work that is in noncompliance.
2. Ensure that all testing required by the specification is performed. All commercially produced products, such as pipe and reinforcing steel, that are used on the project will be accompanied by numerical test results or a certification from the manufacturer that the material meets the applicable standards.
3. Visits the testing laboratory to determine if it has the equipment and qualified personnel necessary to conduct the tests required by the specifications.
4. Ensures that tests are performed at the frequency stated in the specifications. Determines when and where tests will be taken and witnesses tests. If not indicated in the specifications, a sufficient number of tests are performed to verify that the construction is acceptable.
5. Reviews test reports and certifications for conformance with the specifications. Each test

report for material in-place, at a minimum, will contain the following:

- a. Test performed and date.
  - b. Applicable standard or project specification.
  - c. Test location.
  - d. Test result.
  - e. Action taken on failing tests.
  - f. Lot size and location and adjusted contract price when statistical acceptance procedures are specified or when provisions allow for reduced payment.
6. Maintains a file of test reports and certifications.
  7. Informs the contractor of deficiencies so corrections can be made and retesting performed prior to covering any substandard work with additional material.
  8. Documents quantities of materials used on the project by actual measurements and computations in a field notebook or computer printouts retained in a folder. For materials paid for on a weight basis, a summary of the material placed each day will be kept in the field notebook. The notebook and/or computer printouts, supported by the original set of weight tickets, are the basis for payment.
  9. Maintains a set of working drawings on the job site that can be used to prepare “as-built” drawings.
  10. Reviews payment requests from the contractor.
  11. Maintains a diary that contains daily entries made and signed by the resident engineer. Each entry should include the following, plus any additional pertinent data:
    - a. Date and weather conditions.
    - b. Names of important visitors.
    - c. Construction work in progress and location.
    - d. Size of contractor’s work force and equipment in use.
    - e. Number of hours worked per day for contractor and subcontractor.
    - f. The substance of important conversations with the contractor about conduct, progress, changes, test results, interpretations of specifications, or other details.
  12. Submits copies of FAA Form 5370-1, *Construction Progress and Inspection Report*, or equivalent form to the appropriate FAA Airports Division/District/Field Office upon request.

#### **IV. CONSTRUCTION MATERIALS QUALITY ASSURANCE TESTING**

Thomas & Associates (herein called the “QA Testing Firm”) will provide the required material testing for the construction phase of the project. The QA Testing Firm will be under contract with the Sponsor and will be responsible for providing the construction materials quality assurance testing in accordance with the technical specifications and this Construction Management Plan. The QA Testing Firm will coordinate directly with the Resident Engineer/Observer. Qualifications and accreditations of the QA Testing Firm and its personnel are included in Appendix B.

The QA Testing Firm will perform the tests described on the following “Construction Material Quality Assurance Tests” table. They will report the test results to the Resident Observer as soon as available using the Construction Materials Test Results forms at Appendix C. Typically, results shall be provided to the Resident Observer verbally within one hour and electronically within one working day.

The Resident Engineer/Observer will initiate appropriate action for all failing tests. The QA Testing Firm may submit other standard report forms for the Engineer’s approval. The proposed form shall include all required information. Additionally, the QA Testing Firm shall provide a monthly summary of all material testing completed and clearly indicate which tests are retests of previously failed, quality assurance tests. The QA Testing Firm shall be responsible for distinguishing in their billing the quality assurance testing required due to previously failed tests.

The Resident Engineer/Observer will evaluate the test results against to the specified acceptance criteria for the applicable test. The Resident Engineer/Observer will notify the Contractor of the test results, whether the results meet the acceptance criteria, and the appropriate action required by the Contractor. The Resident Engineer/Observer and the QA Testing Firm will maintain records of test results.

The QA Testing Firm will use the "Construction Materials Testing Results Form" in Appendix C to provide a Construction Materials Quality Control Summary to the Engineer. The summary will contain a list of all tests performed showing the date, location, pass or fail, results of retests, and whether or not the test is eligible or ineligible under the AIP program. The summary will include a certification that all testing was in accordance with this Construction Management Program. The Engineer shall provide the completed Construction Materials Testing Results Form" to the FAA upon request.

The Engineer will prepare a summary of materials not passing and the penalty called for by the technical specifications. The Engineer will submit the summary to the FAA upon request and will indicate when and to what extent penalties are imposed.

Should test results or observations indicate noncompliance with the Plans and Specifications, the following communication and follow-up action will be implemented, as applicable:

1. Verbal notification to the Construction Observer and Construction Superintendent.
2. Calibration check on equipment used to determine the noncompliance item, if applicable.
3. Confirmation of noncompliance through retesting and/or follow-up observations.
4. If a solution to the nonconformance issue is not reached in a reasonable time frame, additional qualified contractor personnel will be contacted to assist in identifying and correcting the problem.
5. If a severe nonconformance problem is detected and a reasonable solution cannot be implemented in a reasonable time frame, the Construction Superintendent will consult with the Project Engineer and the applicable work will be suspended.
6. The work will commence only after the Construction Superintendent and Project Engineer concur that a solution to the problem has been found and successfully implemented.

### Construction Materials Required Tests

SPEC. NO.	TEST NAME	SAMPLING FREQUENCY	SAMPLING METHOD	TESTING METHOD	TESTING CRITERIA
SS-222	Lab Compaction Characteristics (Modified))	1/material type	ASTM D 75	AASHTO T180 (Method D)	SS-150-3.1
SS-222	Density of Soil In-Place (Nuclear Method)	2 per 1000 SY each lift	ASTM D 3665 & *	AASHTO T310	SS-150-3.1
SS-222	Thickness	1/sublot	ASTM D 3665 & *	N/A	SS-150-3.4
P-152	Classification of Soils(USCS)	1/material type Or *	*	ASTM D 2487	152-2.2e & 152-2.6
P-152	Liquid Limit, Plastic Limit, & Plasticity Index	1/material type Or *	*	ASTM D 4318	152-2.6
P-152	Lab Compaction Characteristics (Standard)	1/material type Or *	*	ASTM D 698	N/A
P-152	Density of Soil In-Place (Nuclear Method)	8 / lot Or *	ASTM D 3665 & *	ASTM D 6938	152-2.2e & 152-2.6
P-610	Slump	1 / Truck Or *	ASTM C 172	ASTM C 143	610-3.2



P-610	Entrained Air	1 / 50 CY	ASTM C 172	ASTM 231	610-3.2
P-610	Compression Testing Specimen Cylinders	1 set** / 100 CY Or *	ASTM C 172	ASTM C 31	610-3.2
P-610	Compressive Strength	1 per Test Cylinder ***	N/A	ASTM C 39	610-3.2

*	“As specified by the Engineer”
**	Each set will consist of 4 specimens each prepared in accordance with ASTM C 31.
***	One cylinder shall be tested at 7 days as an indicator of potential problems with the material. Two cylinders shall be tested at 28 days. The average of the two results shall be reported as the concrete compressive strength ( $f'_c$ ). The reserve cylinder shall be tested in the case of problems with one of the previous breaks.

**APPENDIX A**

**ENGINEERING SUPERVISION & CONSTRUCTION**

**OBSERVATION QUALIFICATIONS**

## Earl Mott, Jr., PE

Director of Construction Services

Earl Mott is a Senior Project Manager and Director of Construction Services and is approaching 20 years of engineering experience. Earl's responsibilities include client contact, project management, consultant coordination, direction of plan and specification production, bidding, and construction management and support. His project experience includes airport design, airfield lighting systems, new electrical vaults, PAPI approach systems, pavement crack cleaning and sealing, terminal building and hangar improvements, parking improvements, perimeter fencing, roadway design, site design, stormwater collection systems, hydrology, and erosion control.

### Education

Bachelor of Science in Civil Engineering, University of Arkansas, 1992

### Professional Registrations

Professional Engineer  
AR, 9250, 1997  
KY, 22872, 2002

### Affiliations

American Society of Civil Engineers

National Society of Professional Engineers

### **Monticello Municipal Airport Runway 3-21 Seal Coat and Pavement Marking and Airfield Signage, Monticello, Arkansas.**

Aviation Business Team Leader provided management including design services and construction administration to seal coat/rejuvenate and mark Runway 3-21, add threshold lights at each end of the runway, and airfield signage.

### **South Arkansas Regional Runway 13-31 Pavement and Lighting Rehabilitation, El Dorado, Arkansas.**

Responsible for the performance of the construction support services phase that included narrowing Runway 13-31 from 150 feet wide to 100 feet, reconstructing failed pavement areas, installing new runway lighting, and constructing new pavement marking. This work included coordinating shop drawing reviews, preparing pay requests, processing requests for information, coordinating the construction observation team, and project close out.

### **Little Rock National Airport Runway 4R Extension, Little Rock, Arkansas.**

Project Leader responsible for construction support on this 1,050-foot runway extension project that includes extension length study, parallel taxiway extension, localizer relocation, MALSR relocation, storm water drainage, arterial and perimeter road relocation, new holding apron construction, and coordination with nine local, state, and federal agencies.

### **LRNA Taxiway D Rehabilitation, Little Rock, Arkansas.**

Project Leader responsible for providing management and oversight including design, FAA and grant coordination, and construction support services. The project rehabilitated Taxiway D as a 75-foot-wide concrete taxiway with adequate strength to be considered a heavy aircraft route.



## **Blake Roberson, PE**

Aviation Engineer

Blake Roberson is a Project Manager in our Aviation Group with more than seven years of experience. Blake's responsibilities include design coordination, plan preparation, specification preparation, client contact, and construction management. Blake has experience working at numerous Arkansas air carrier and general aviation airports. Blake's airport and site development project experience includes runway extensions, parallel taxiway extensions, pavement overlays, runway safety area improvements, utility installation, hangar construction, pavement rehabilitation, ramp expansion, property acquisition, and parking lots.

### **Education**

Bachelor of Science in Civil Engineering, University of Arkansas, 2003

### **Professional Registrations**

Professional Engineer  
AR, 13646, 2008

### **Affiliations**

American Society of Civil Engineers

National Society of Professional Engineers

### **Woodruff County Runway Sealcoat and Marking, Augusta, Arkansas.**

Aviation Engineer responsible for plans and specifications, construction management and observation, and grant assistance to seal coat the runway, taxiway, and apron, and to remark the runway pavement with non-precision markings.

### **Saline Co. Airport Parallel Taxiway Construction, Bryant, Arkansas.**

Project Leader responsible for the construction phase for a parallel taxiway and terminal area fencing. Responsibilities included Commission correspondence, grant closeout, site visits, pavement management plan, and construction support and administration.

### **Little Rock National Airport Runway 18-36 Extension, Little Rock, Arkansas.**

Project Leader responsible for managing construction for the first stage of a 1,100-foot extension of the general aviation runway located on the west side of the airfield. Reviewed submittals and coordinated construction activities with construction observer. Extending the runway will result in the extension of two taxiways, relocation of the perimeter road, construction of the relocated runway safety area, installation of the associated lighting and navigational aids, relocation of existing water and sewer mains, and relocation of a city street.

### **Monticello Municipal Airport Terminal Area Fencing, Monticello, Arkansas.**

Project Leader responsible for design, bidding, and construction support services for the construction of approximately 5,400 linear feet of 7-foot chain link fence in the terminal area with a barbed wire extension, one 20-foot automatic sliding cantilever gate and operator system, three 20-foot manual double-swing gates, and two 4-foot pedestrian gates.



## Jim Ward

Construction Observer

Jim Ward is a Senior Construction Observer with more than 35 years of experience. Jim's responsibilities include ensuring that the contractor and subcontractors are working in accordance with the plans and specifications, that survey work has the proper controls for accurate placement of structures and grades, and that materials kept on site are properly stored and inventoried. He has experience with major projects including an \$80 million hydroelectric project, \$12 million airport concrete paving, and an \$8 million dam and roadway project. He has performed and supervised field laboratory work on major projects for soils and concrete testing including proctors, sieve analysis, classifications field densities, concrete cylinder, and other field quality assurance tests.

### Education

Bachelor of Science,  
Mathematics, Arkansas Tech,  
Russellville, Arkansas, 1974

### Professional Registrations

Explosives Users & Blasters  
AR, BC1193, 1999

### Affiliations

American Concrete Institute

Jim has provided construction observation services for the following projects:

- Almyra Airport Ramp Rehabilitation, Almyra, Arkansas.
- Arkadelphia Municipal Airport Taxiway Lighting, Arkadelphia, Arkansas.
- Arkansas International Airport Runway Lighting Rehabilitation, Blytheville, Arkansas.
- Arkadelphia Municipal Airport Airfield Pavement Rehabilitation, Arkadelphia, Arkansas.
- Hope Airport North Parallel Taxiway Construction, Hope, Arkansas.
- Marked Tree Airport RW Extension Construction, Marked Tree, Arkansas.
- Mena Intermountain Municipal Airport Taxiway Improvements, Mena, Arkansas.
- Warren Airport - Installation of Automated Fuel System and Runway 3 PAPI, Warren, Arkansas.
- Warren Airport Runway Widening, Warren, Arkansas.
- DRA Stage 1B Constr and Stage 2A Design, Colt, Arkansas.
- South Arkansas Regional Airport Runway 13-31 Rehab, Fence, and Localizer, El Dorado, Arkansas.
- South Arkansas Regional Airport Runway 13-31 Rehabilitation Stage 3, El Dorado, Arkansas.
- ELD Taxiway Rehabilitation, El Dorado, Arkansas.
- El Dorado Taxiway Rehabilitation Phase 2, El Dorado, Arkansas.
- Fort Smith Regional Airport Airfield Pavement Rehab - Phase 1, Fort Smith, Arkansas.
- LRNA Runway 4R Extension - Stage 2, Little Rock, Arkansas.
- Little Rock National Airport Runway 18-36 Extension, Little Rock, Arkansas.
- Little Rock National Airport Runway 4R Extension, Little Rock, Arkansas.
- Little Rock National Airport Taxiway "A" Relocation and Perimeter Road, Little Rock, Arkansas.
- Marianna Airport Parallel Taxiway Extension to Runway 18, Marianna, Arkansas.
- Monticello Municipal Airport Taxiway Reconstruction and Agricultural Operations Access, Monticello, Arkansas.
- Newport Runway 18/36 Rehabilitation - Phase III, Newport, Arkansas.



## Petey Chambless

Construction Observer

Petey Chambless is a Senior Construction Observer with 25 years of experience. Petey's responsibilities include ensuring that the contractor and subcontractors are working in accordance with the plans and specifications, that survey work has proper controls for accurate placement of structures and grades, and that on-site materials are properly stored and inventoried. Petey also maintains daily weather, contractor's forces, work completed and contract time used records, reviews the results of project site testing, monitors work schedules, and alerts the design staff to potential problems in construction and scheduling conflicts. In addition, Petey has been in charge of inspection and field testing on numerous concrete and asphalt paving projects as well as bridge and treatment plant work involving heavy reinforced concrete construction.

### Professional Registrations/Certifications

Troxler Nuclear Certification, 1985  
 ACI Concrete Field Testing Technician Grade I, 1985  
 Class II Sewage Collection & Treatment, 11-429, 1985  
 Class IV Water License, LA, 005676, 1985  
 Master Electrician, 1883, 2000  
 Explosives Users & Blasters, E0025608, 1985

Petey has provided construction observation for the following projects:

- Almyra Airport Ramp Rehabilitation, Almyra, Arkansas.
- Arkadelphia Municipal Airport Lighting Rehabilitation, Arkadelphia, Arkansas.
- Arkadelphia Municipal Airport Taxiway Lighting, Arkadelphia, Arkansas.
- Arkansas International Airport Runway Lighting Rehabilitation, Blytheville, Arkansas.
- Arkansas International Airport Runway Repair, Blytheville, Arkansas.
- Hope Airport North Parallel Taxiway Construction, Hope, Arkansas.
- Hope Municipal Airport South Parallel Taxiway Extension, Hope, Arkansas.
- Marked Tree Airport Terminal Area Perimeter Fencing, Marked Tree, Arkansas.
- Marked Tree Airport Sealcoat, Marked Tree, Arkansas.
- Melbourne Airport Pavement Rehabilitation and REILs Installation, Melbourne, Arkansas.
- Mena Intermountain Municipal Airport Taxiway Improvements, Mena, Arkansas.
- Monticello Municipal Airport Runway 3-21 Seal Coat and Pavement Marking and Airfield Signage, Monticello, Arkansas.
- DRA Stage 1B Construction and Stage 2A Design, Colt, Arkansas.
- South Arkansas Regional Airport Runway 13-31 Rehab, Fence, and Localizer, El Dorado, Arkansas.
- South Arkansas Regional Airport Runway 13-31 Rehabilitation Stage 3, El Dorado, Arkansas.
- El Dorado Taxiway Rehabilitation Phase 2, El Dorado, Arkansas.
- LRNA Runway 4R Extension - Stage 2, Little Rock, Arkansas.
- LRNA Rehabilitation of Runway 18-36, Little Rock, Arkansas.
- Little Rock National Airport Runway 18-36 Extension, Little Rock, Arkansas.
- Little Rock National Airport Runway 4R Extension, Little Rock, Arkansas.
- North Little Rock Airport West GA Drainage Stage III, North Little Rock, Arkansas.

**APPENDIX B**

**QA TESTING FIRM CONTRACT AND  
QUALIFICATIONS**

## CONTRACT

THIS AGREEMENT Made this \_\_\_\_\_ day of \_\_\_\_\_, 20\_\_\_\_, by and between the City of Conway, Arkansas, acting through its duly authorized representatives, party of the first part, hereinafter called the "OWNER", and:

**Thomas & Associates, Inc.**

---

party of the second part, hereinafter called "TESTING FIRM".

### W I T N E S S E T H:

That for and in consideration of the payment hereinafter mentioned, to be made and performed by the OWNER, the TESTING FIRM hereby agrees with the OWNER to commence and complete the construction materials testing for the project "Stage 1A – Grading and Drainage Construction" at Conway Municipal Airport.

The TESTING FIRM, having examined the Technical Specifications, hereby agrees to furnish all tools, appliances, equipment and specified materials, and perform all necessary labor for "Construction Materials Quality Control Testing" for the project "Stage 1A – Grading and Drainage Construction" at Conway Municipal Airport, in strict accordance with the Technical Specifications at and for the unit prices agreed to herein.

The numbers of tests shown on the Unit Price Schedules are estimated. The actual number of tests performed will be determined by the Engineer. Some tests may not be performed. The quantity of tests to be paid for will be the actual number of tests performed in accordance with the Technical Specifications and accepted by the Engineer.

The TESTING FIRM agrees to perform the work in accordance with the Technical Specifications and all provisions attached hereto and made a part hereof as though copied in full herein, for and at the prices agreed upon herein.

During the performance of this contract, the TESTING FIRM, for itself, its assignees and successors in interest, agrees as follows:

1. The FAA, Airport Owner, Comptroller General of the United States or any of their duly authorized representatives shall have access to any books, documents, papers and records of the TESTING FIRM which are directly pertinent to a specific grant program for the purpose of making audit, examination, excerpts, and transcription. The TESTING FIRM shall maintain all required records for 3 years after the Airport Owner makes final payment and all other pending matters are closed.
2. Compliance with Regulations. The TESTING FIRM shall comply with the Regulations relative to nondiscrimination in federally assisted programs of the Department of Transportation (hereinafter, "DOT") Title 49, Code of Federal Regulations, Part 21, as they may be amended from time to time, (hereinafter referred to as the Regulations), which are herein incorporated by reference and made a part of this contract.



3. Nondiscrimination. The TESTING FIRM, with regard to the work performed by it during the contract, shall not discriminate on the grounds of race, color, or national origin in the selection and retention of subcontractors, including procurements of materials and leases of equipment. The TESTING FIRM shall not participate either directly or indirectly in the discrimination prohibited by section 21.5 of the Regulations, including employment practices when the contract covers a program set forth in Appendix B of the Regulations.
4. Solicitations for Subcontracts, Including Procurements of Materials and Equipment. In all solicitations either by competitive bidding or negotiation made by the TESTING FIRM for work to be performed under a subcontract, including procurements of materials or leases of equipment, each potential subcontractor or supplier shall be notified by the TESTING FIRM of the TESTING FIRM's obligations under this contract and the Regulations relative to nondiscrimination on the grounds of race, color, or national origin.
5. Information and Reports. The TESTING FIRM shall provide all information and reports required by the Regulations or directives issued pursuant thereto and shall permit access to its books, records, accounts, other sources of information, and its facilities as may be determined by the Airport Owner or the FAA to be pertinent to ascertain compliance with such Regulations, orders, and instructions. Where any information required of a TESTING FIRM is in the exclusive possession of another who fails or refuses to furnish this information, the TESTING FIRM shall so certify to the Engineer, Airport Owner or the FAA, as appropriate, and shall set forth what efforts it has made to obtain the information.
6. Sanctions for Noncompliance. In the event of the TESTING FIRM's noncompliance with the nondiscrimination provisions of this contract, the Engineer shall impose such contract sanctions as it or the FAA may determine to be appropriate, including, but not limited to:
  - 6.A withholding of payments to the TESTING FIRM under the contract until the TESTING FIRM complies, and/or:
  - 6.B cancellation, termination, or suspension of the contract, in whole or in part.
7. Incorporation of Provisions. The TESTING FIRM shall include the provisions of paragraphs 1 through 6 in every subcontract, including procurements of materials and leases of equipment, unless exempt by the Regulations or directives issued pursuant thereto. The TESTING FIRM shall take such action with respect to any subcontract or procurement as the Engineer, Airport Owner or the FAA may direct as a means of enforcing such provisions including sanctions for noncompliance. Provided, however, that in the event TESTING FIRM becomes involved in, or is threatened with, litigation with a subcontractor or supplier as a result of such direction, the TESTING FIRM may request the Engineer to enter into such litigation to protect the interests of the Engineer, and in addition, the TESTING FIRM may request the Airport Owner to enter into such litigation to protect the interests of the Owner and, in addition, the TESTING FIRM

may request the United States to enter into such litigation to protect the interests of the United States.

8. Disadvantaged Business Enterprise Policy. It is the policy of the Department of Transportation (DOT) that disadvantaged business enterprises as defined in 49 CFR Part 23 shall have the maximum opportunity to participate in the performance of contracts financed in whole or in part with Federal funds under this agreement. Consequently, the DBE requirements of 49 CFR Part 23 apply to this agreement.
9. DBE Obligation. The TESTING FIRM agrees to ensure that minority business enterprises as defined in 49 CFR Part 23 have the maximum opportunity to participate in the performance of contracts and subcontracts financed in whole or in part with Federal funds provided under this agreement. In this regard, all TESTING FIRMS shall take all necessary and reasonable steps in accordance with 49 CFR Part 23 to ensure that minority business enterprises have the maximum opportunity to compete for and perform contracts. TESTING FIRM shall not discriminate on the basis of race, color, national origin, or sex in the award and performance of DOT-assisted contracts.

The OWNER agrees to pay, and the TESTING FIRM agrees to accept, as full and final compensation for all work done under this agreement, the price agreed upon herein, said payments to be made in lawful money of the United States at the time and in the manner set forth in the Specifications.

For the consideration above expressed, the TESTING FIRM agrees to perform the work in a timely matter during the construction of the project.

**CONWAY MUNICIPAL AIRPORT  
STAGE 1A - GRADING AND DRAINAGE  
CONSTRUCTION MATERIALS TESTING  
UNIT PRICES**

ITEM NO.	SPEC. NO.	TEST NAME	UNIT	ESTIMATED QUANTITY	UNIT PRICE	EXTENDED AMOUNT
1	SS-222	Lab Compaction Characteristics (Modified - AASHTO T180 Method D)	EA	2	\$ 161.00	\$ 322.00
2	SS-222	Density of Soil In-Place (Nuclear Method AASHTO T310)	EA	20	\$ 32.00	\$ 640.00
3	SS-222	Thickness	EA	20	\$ 15.00	\$ 300.00
4	P-152	Classification of Soils (USCS)	EA	8	\$ 57.50	\$ 460.00
5	P-152	Liquid Limit, Plastic Limit, & Plasticity Index	EA	8	\$ 46.00	\$ 368.00
6	P-152	Lab Compaction Characteristics (Standard ASTM D 698)	EA	8	\$ 161.00	\$ 1,288.00
7	P-152	Density of Soil In-Place (Nuclear Method ASTM D 6938)	EA	420	\$ 32.00	\$ 13,440.00
8	P-610	Slump	EA	2	\$ 17.00	\$ 34.00
9	P-610	Entrained Air (Pressure Method)	EA	2	\$ 17.00	\$ 34.00
10	P-610	* Compression Testing Specimen Set (4 Cylinders per set)	EA	2	\$ 140.00	\$ 280.00
11	P-610	Compressive Strength (1 Cylinder)	EA	8	\$ 11.50	\$ 92.00
12	N/A	* Technician	HR	250	\$ 30.00	\$ 7,500.00
13	N/A	* Mobilization	EA	50	\$ 130.00	\$ 6,500.00

**Estimated Materials Testing Cost**     \$ 29,996.00

**\* NOTES:**

1. One cylinder shall be tested at 7 days as an indicator of potential problems with the material. Two cylinders shall be tested at 28 days. The average of the two results shall be reported as the concrete compressive strength (f'c). The reserve cylinder shall be tested in the case of problems with one of the previous breaks.
2. Mobilization shall include all charges, including labor hours, required for mobilization to the site. Technician time shall consist of only the time the testing personnel is on the project site.

IN WITNESS WHEREOF, the parties of these presents have executed this Contract in four (4) counterparts, each of which shall be deemed an original on the day and year first above written.

**CITY OF CONWAY, ARKANSAS**

ATTEST:

\_\_\_\_\_

By \_\_\_\_\_  
(Party of the First Part)

Title \_\_\_\_\_

**THOMAS & ASSOCIATES, INC.**

ATTEST:

\_\_\_\_\_

By \_\_\_\_\_  
(Party of the Second Part)

Title \_\_\_\_\_

SEAL (If a Corporation)

# **Enice Thomas, Jr.**

## **President, Thomas & Associates, Inc.**

### ***Project Team Role***

Materials Testing

### ***Related Training***

Concrete Field Testing Technician

Troxler course - Nuclear Testing Equipment

National Highway Institute: Asphalt Surface Treatment, Maintenance of Gravel Roads, Maintenance of Roadway Drainage, Bridge Rehabilitation, Soil Stabilization; Training Course for Worksite Traffic Supervisors; Public Relations Course.

### ***Representative Projects***

- ➔ Runway 22R Extension. Little Rock National Airport, Little Rock, Arkansas.
- ➔ East Airfield Access Road. Arkansas International Airport, Blytheville, Arkansas.
- ➔ Hangar 455 Improvements. Arkansas International Airport, Blytheville, Arkansas.
- ➔ Sidewalk and Street Improvements. Don Stephens Construction Company, Haynes, Arkansas.
- ➔ Allen Street Drainage and Street Improvements. Don Stephens Construction Company, North Little Rock, Arkansas.
- ➔ Airfield Pavement Rehabilitation. Arkansas International Airport, Blytheville, Arkansas.
- ➔ Runway 4L-22R Rehabilitation including Taxiway Connections. Little Rock National Airport, Little Rock, Arkansas.
- ➔ Terminal Area Paving Improvements. Little Rock National Airport, Little Rock, Arkansas.
- ➔ Airfield Pavement Rehabilitation. Little Rock National Airport. Little Rock, Arkansas.
- ➔ West Memphis Municipal Airport, West Memphis, Arkansas.
- ➔ Forrest City Housing Rehabilitation, Forrest City, Arkansas.
- ➔ Taxiway P Reconstruction, Little Rock National Airport
- ➔ Taxiway B & D Reconstruction, Little Rock National Airport
- ➔ Parallel Taxiway to Runway 7-25, Arkadelphia Municipal Airport
- ➔ Runway, Taxiway & Apron Slab Repair, Arkansas International Airport
- ➔ Apron Rehabilitation, Pine Bluff Municipal Airport
- ➔ Sand & Gravel Exploration, Wilcox Property, North Little Rock, Arkansas
- ➔ Taxiway C Rehabilitation; Perimeter Road Paving; Runway 22R ILS/ALS site work; Runway 22R Extension including Taxiway F, C, and M paving and lighting; West Perimeter Road – North construction and paving; Runway 18-36 rehabilitation; terminal electrical upgrade – Little Rock National Airport.
- ➔ Runway 5-23 Overlay, Heber Springs, Arkansas.
- ➔ Runway 16-34, Taxiway Overlay, Wynne Municipal Airport.

**APPENDIX C**  
**MATERIAL TESTING REPORT FORM**

# Construction Materials Testing Results Form

**Project:** Conway Municipal Airport – Stage 1A – “Grading and Drainage Construction”

**AIP No:** 3-05-0089-003-2010

**Date:**

**Testing Firm:** Thomas & Associates, Inc.

**Engineer:** Garver, LLC

**Report Type:**

Specification No.	Test Name	Testing Method (ASTM No.)	Location	Test Result	Required Acceptance Level	Pass/Fail	Retest (T)	AIP Eligible (T)	Remarks (Action taken on Failed Tests)

**CERTIFICATION:** The above listed testing was completed in accordance with the Construction Materials Acceptance Sampling and Testing Plan and the applicable sections of the Technical Specifications.

\_\_\_\_\_  
Construction Observer

Page \_\_\_\_\_ of \_\_\_\_\_

**APPENDIX D**

**FAA FORM 5370-1**

**CONSTRUCTION PROGRESS AND INSPECTION**

**REPORT (EXAMPLE)**





U.S. Department  
of Transportation  
**Federal Aviation  
Administration**

**CONSTRUCTION PROGRESS AND INSPECTION  
REPORT  
AIRPORT GRANT PROGRAM**

Period Ending

Project Number

**3-05-0089-003-2010**

Airport Name

**Conway Municipal Airport**

Project Description

**Stage 1A - Grading and Drainage Construction**

Contractor's Name

1. Rough Estimate of Percent Completion to Date of Construction Phases *(Include items such as clearing, grading, drainage, base, surface, lighting, etc.)*

2. Work Completed or in Progress this period

3. Brief Weather Summary This Period Including Approximate Rainfall and Periods of Below Freezing Temperature  
*(On earthwork jobs include soil conditions)*

4. Contract Time

No Days  
Charged To  
Date

Last Working  
Day Charged  
(Date)

5. Summary of Laboratory and Field Testing This Period *(note failing tests and any retests Summarize out-of-tolerance material. Identify material subject to pay reduction.)*

6. Describe Anticipated Work by Contractor for Next Period

7. Problem Areas/Other Comments *(Revisions to plans and specifications approved or denied, delays, difficulties, etc. and actions taken.)*

**SPONSOR'S INSPECTOR OR REPRESENTATIVE**

Date

Typed of Printed Name and Title

Signature

INSTRUCTIONS FOR PREPARATION OF FAA FORM 5370-1 (8-89)  
**CONSTRUCTION PROGRESS AND INSPECTION REPORT**  
**AIRPORT GRANT PROGRAM**

This preaddressed form is to be filled out, with ballpoint pen or typewriter by the Sponsor's Inspector on the project, folded with return address out, fastened, and mailed to the address shown below. No postage is required since the postage has been prepaid by the Federal Aviation Administration.

Submit one copy for each report. If additional space is required to complete any of the items, continue on a separate sheet of plain paper, identifying it with the project number, fold and insert inside the report before mailing.

If additional blank copies of the form are required, submit your request to the address provided below.

☆ U.S. GPO:1989-261-335/03364

TAB OR TAPE HERE

**1st**  
**Fold**

**2nd**  
**Fold**

U.S. Department  
of Transportation  
**Federal Aviation  
Administration**

800 Independence Avenue, S.W.  
Washington, D.C. 20591

Official Business  
Penalty for Private Use \$200



**NO POSTAGE  
NECESSARY  
IF MAILED  
IN THE  
UNITED  
STATES**



**POSTAGE WILL BE PAID BY THE FEDERAL AVIATION ADMINISTRATION**

**Federal Aviation Administration  
AR/OK ADO, ASW-630  
2601 Meacham Blvd.  
Fort Worth, TX 76137**





## Housing Authority of the City of Conway

---

---

MARYANNBOYD  
Executive Director

May 26<sup>th</sup>, 2011

Honorable Mayor Tab Townsell & City Council  
City of Conway  
1201 Oak Street  
Conway, AR 72032

Dear Mayor and City Council Members:

The term of Geneva Stephens as a commissioner on the Board of the Housing Authority of the City of Conway, expires on January 15<sup>th</sup>, 2011.

At the Annual meeting held January 24, 2011, the Board voted to recommend that Mrs. Stephens be re-appointed for another five year term beginning January 15<sup>th</sup>, 2011. The Board requests the approval of the City Council as to this appointment.

Sincerely,

A handwritten signature in cursive script that reads "Mary A. Boyd".

Mary A. Boyd  
Executive Director

MB:nh



**City of Conway, Arkansas**  
**Resolution No. R-11-\_\_\_\_\_**

**A RESOLUTION BY THE CITY COUNCIL IN SUPPORT OF A SAFE ROUTES TO SCHOOL GRANT APPLICATIONS FOR SIDEWALKS AND TRAFFIC CALMING MEASURES ALONG SIEBENMORGAN ROAD, BILL LUCY DRIVE, LEE STREET, MANOR DRIVE, AND STERMER ROAD.**

**Whereas**, the City of Conway is proud to be the home of the Conway Safe Routes to School (SRTS) Committee, which has shown a remarkable commitment to the well-being of children within their respective school zones; and

**Whereas**, The Conway Safe Routes to School master plan has been drafted and approved by resolution to affect the implementation, operation, education, infrastructure development, and evaluation of the City of Conway's SRTS program; and

**Whereas**, two currently active Arkansas SRTS grants are being utilized to afford the SRTS Committee operating capital and funds for their 2011-2012 education and promotion campaign; and

**Whereas**, an application for reimbursable Arkansas SRTS Infrastructure grant is being sought to add sidewalks and traffic calming measures along portions of Siebenmorgan Road, Bill Lucy Drive, Lee Street, Manor Drive, and Stermer Road; and

**Whereas**, these sidewalks and traffic calming measures are particularly needed in order to encourage and aid in safe pedestrian and bicyclist activities in the Carl Stuart Middle, Bob Courtway Middle, Ray Simon Intermediate, Theodore Jones Elementary, Ida Burns, and Marguerite Vann Elementary school zones; and

**Whereas**, the City of Conway understands that there will be no reimbursement for any work accomplished prior to the issuance by the Arkansas State Highway and Transportation Department of an official Notice to Proceed; and

**Whereas**, this project, using federal funding, will be open and available for use by the general public and maintained by the City of Conway in perpetuity; and

**Whereas**, the Conway City Council desires to add its support to the seeking of this grant

**NOW, THEREFORE, BE IT RESOLVED BY THE CITY COUNCIL OF THE CITY OF CONWAY, ARKANSAS:**

**Section 1** That the City of Conway will participate in accordance with its designated responsibility, including the perpetual maintenance of this project.

**Section 2:** That the Mayor and Director of Planning and Development are hereby authorized and directed to execute all appropriate agreements.

**Section 3:** That the City of Conway, Arkansas does hereby express its support for the application of a Safe Routes to School Infrastructure grant to improve pedestrian and bicycling activities in the Carl Stuart Middle, Bob Courtway Middle, Ray Simon Intermediate, Theodore Jones Elementary, Ida Burns, and Marguerite Vann Elementary school zones.

**PASSED THIS 24<sup>th</sup>** day of May, 2011

**Approved:**

**Attest:**

\_\_\_\_\_  
**Mayor Tab Townsell**

\_\_\_\_\_  
**Michael O. Garrett**  
**City Clerk/Treasurer**



**City of Conway, Arkansas**  
**Resolution No. R-11- \_\_\_\_\_**

**A RESOLUTION BY THE CITY COUNCIL IN SUPPORT OF A JOINT-USE AGREEMENT GRANT WITH CONWAY HIGH SCHOOL WEST FOR THE PURPOSE OF LAUREL PARK TENNIS COURT USE AND NEW LIGHTING.**

**Whereas**, the City of Conway has traditionally allowed the women's and men's tennis teams of Conway High School West to utilize the tennis courts at Laurel Park; and

**Whereas**, the City of Conway has maintained the courts without compensation; and

**Whereas**, the Conway High School West has received grant money through the State Department of Education to replace the lighting at Laurel Park; and

**Whereas**, the conditions of the grant mandate that the School and the City enter into a legal Joint-Use Agreement for the facility's use; and

**NOW, THEREFORE, BE IT RESOLVED BY THE CITY COUNCIL OF THE CITY OF CONWAY, ARKANSAS:**

**Section 1:** That the City of Conway, Arkansas does hereby express its support for the Joint-Use Agreement and a grant to aide with the application of said agreement. The Director of Parks and/or the Assistant to the Mayor for Community Development will be the City representative with the authority to sign agreements and contracts regarding the project.

**PASSED this 24<sup>th</sup> day of May, 2010**

**Approved:**

\_\_\_\_\_  
**Mayor Tab Townsell**

**Attest:**

\_\_\_\_\_  
**Michael O. Garrett**  
**City Clerk/Treasurer**



**City of Conway, Arkansas**  
**Ordinance No. O-11- \_\_\_\_\_**

**AN ORDINANCE AMENDING SECTIONS 201.1 AND 201.3 OF THE CONWAY ZONING ORDINANCE TO REZONE PROPERTY LOCATED AT 2002 DAVE WARD DRIVE FROM R-2 TO O-3:**

**NOW, THEREFORE, BE IT ORDAINED BY THE CITY COUNCIL OF THE CITY OF CONWAY, ARKANSAS THAT:**

**SECTION 1:** The Zoning District Boundary Map of the Conway Land Development Code be amended by changing all the **R-2** symbols and indications as shown on the Zoning District Boundary Map in an area described as follows:

Part of the SW¼ NW¼ of Section 13, Township 5 North, Range 14 West, Faulkner County, Arkansas, described as follows: from the Southeast Corner of Harlan Park Subdivision as shown on plat of record in Plat Book A, Page 212, run East 200 feet to the point of beginning; run thence North 140 feet; run thence East 150 feet; run thence South 140 feet; run thence West 150 feet to the point of beginning, less and except that portion thereof conveyed to Arkansas State Highway Commission by deed recorded in the official records of Faulkner County, Arkansas, as Document #2000-16471.

to those of **O-3**, and a corresponding use district is hereby established in the area above described and said property is hereby rezoned.

**SECTION 2:** All ordinances in conflict herewith are repealed to the extent of the conflict.

**PASSED** this 24<sup>th</sup> day of May, 2011.

**Approved:**

\_\_\_\_\_  
**Mayor Tab Townsell**

**Attest:**

\_\_\_\_\_  
**Michael O. Garrett**  
**City Clerk/Treasurer**



## CONWAY PLANNING COMMISSION

1201 OAK STREET CONWAY, AR 72032 (501) 450-6105

May 17, 2011

Council Members  
Conway, AR 72032

Dear Council Members:

Anthes Family Trust request for rezoning from R-2 to O-3 for property located at 2002 Dave Ward Drive with the legal description:

Part of the SW¼ NW¼ of Section 13, Township 5 North, Range 14 West, Faulkner County, Arkansas, described as follows: from the Southeast Corner of Harlan Park Subdivision as shown on plat of record in Plat Book A, Page 212, run East 200 feet to the point of beginning; run thence North 140 feet; run thence East 150 feet; run thence South 140 feet; run thence West 150 feet to the point of beginning, less and except that portion thereof conveyed to Arkansas State Highway Commission by deed recorded in the official records of Faulkner County, Arkansas, as Document #2000-16471.

was reviewed by the Planning Commission at its regular meeting on May 16, 2011. The Planning Commission voted 6 – 0 that the request be sent to the City Council with a recommendation for approval.

Submitted by,

Kent Mathis, Chairman  
Planning Commission

# CITY OF CONWAY

## PAUL ANTHES REZONE R-2 TO O-3

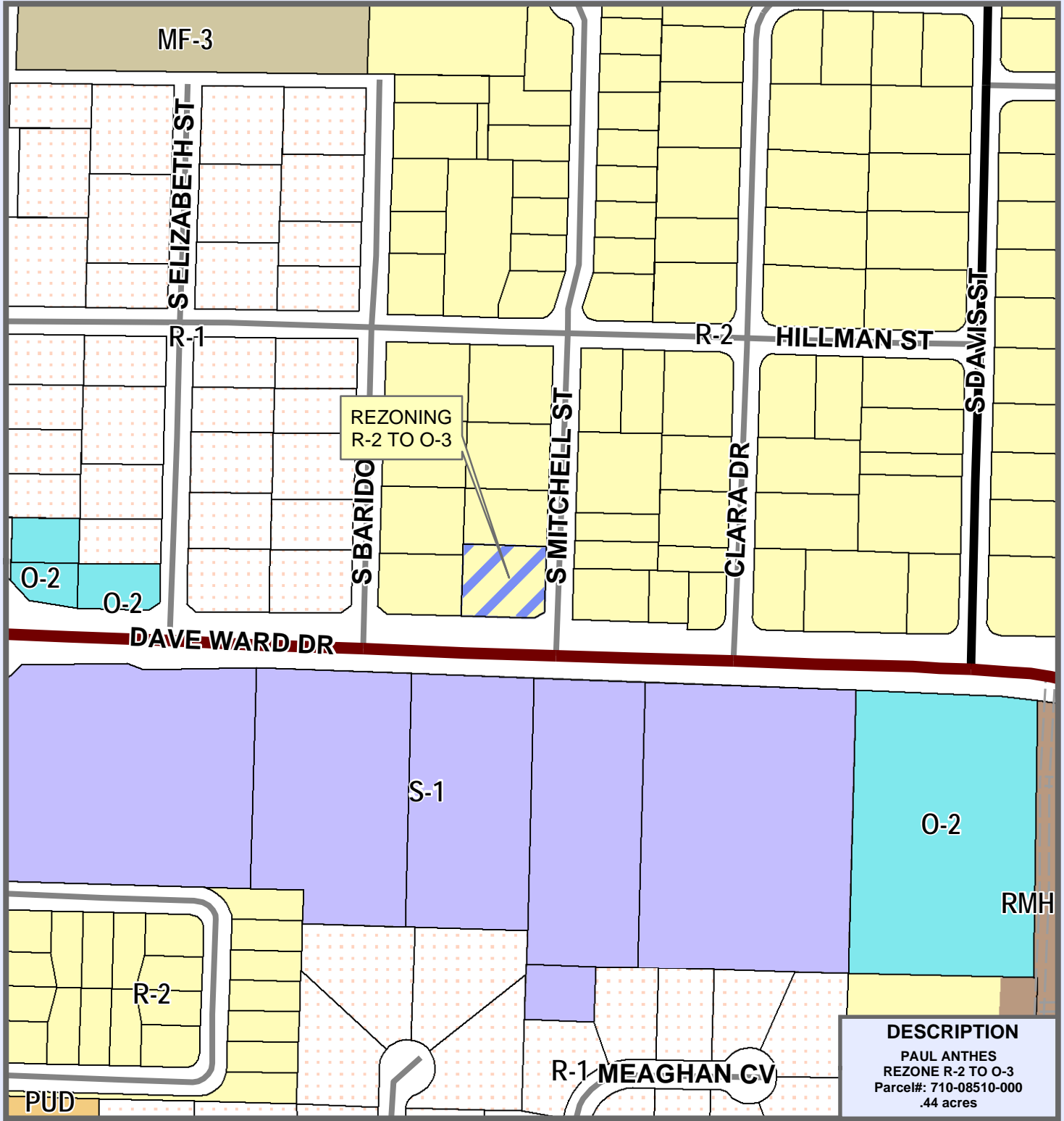

**DESCRIPTION**  
 PAUL ANTHES  
 REZONE R-2 TO O-3  
 Parcel#: 710-08510-000  
 .44 acres

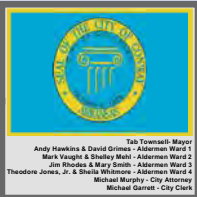

INTERSTATE	LOT LINE	Residential	Industrial
MAJOR ARTERIAL	STREAMS	R-1	I-1
MINOR ARTERIAL	LAKES & PONDS	R-2A	MF-2
COLLECTOR	CITY LIMITS	R-2	MF-3
RESIDENTIAL		HR	RMH
PRIVATE ROAD		SR	
INTERSTATE RAMP		Commercial Office	Special
RAILROADS		C-1	O-1
		C-2	O-2
		C-3	O-3
		C-4	PUD
			TJ

0	25	50	100	150
1 in = 250 ft				
MAY 2011				

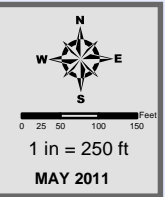

THIS MAP WAS PREPARED BY THE CITY OF CONWAY PLANNING AND DEVELOPMENT DEPARTMENT FOR ITS USE AND MAY BE REVISED AT ANY TIME WITHOUT NOTIFICATION TO ANY USER. THE CITY OF CONWAY PLANNING AND DEVELOPMENT DEPARTMENT DOES NOT GUARANTEE THE CORRECTNESS OR ACCURACY OF ANY FEATURES ON THIS MAP. CITY OF CONWAY ASSUMES NO RESPONSIBILITY IN CONNECTION THEREWITH.

**CONTACT INFORMATION**  
 LANDMARK GIS WEBSITE:  
 gis.cityofconway.org (UNDER DEVELOPMENT)  
 E-MAIL: Jason.Lyon@CityofConway.org





**City of Conway, Arkansas**  
**Ordinance No. O-11- \_\_\_\_\_**

**AN ORDINANCE AMENDING SECTIONS 201.1 AND 201.3 OF THE CONWAY ZONING ORDINANCE TO REZONE PROPERTY LOCATED AT 605, 615, AND 725 DONAGHEY AVENUE; 2111 AND 2117 LOUVENIA AVENUE; 2118 AND 2120 ADA AVENUE; 720 WESTERN AVENUE; 2229 ROBINSON AVENUE; AND 2135 CALDWELL STREET FROM R-2A TO S-1:**

**NOW, THEREFORE, BE IT ORDAINED BY THE CITY COUNCIL OF THE CITY OF CONWAY, ARKANSAS THAT:**

**SECTION 1:** The Zoning District Boundary Map of the Conway Land Development Code be amended by changing all the **R-2A** symbols and indications as shown on the Zoning District Boundary Map in an area described as follows:

E 40' of the S 93' of Lot 14, and the S 93' of Lots 15 and 16, Block D, Smith's Subdivision; S 100' of Lots 1, 2, and 3, Block A, Smith's Subdivision; Lots 3, 4, and 5 Block D, Smith's Subdivision; S 93' of Lot 13, and the S 93' of the W 10' of Lot 14, Block D, Smith's Subdivision; Lots 11 and 12, Block D, Smith's Subdivision; N 115' of Lot 10, Block B, and the N128' of Lot 9, Block B, Smith's Subdivision; W 1/2 of Lot 7, and all of Lot 8, Block B, Smith's Subdivision; and the E 70' of the W 150' of Lot 3, B.G. Wilson's Map of Conway.

to those of **S-1**, and a corresponding use district is hereby established in the area above described and said property is hereby rezoned.

**SECTION 2:** All ordinances in conflict herewith are repealed to the extent of the conflict.

**PASSED** this 24<sup>th</sup> day of May, 2011.

**Approved:**

\_\_\_\_\_  
**Mayor Tab Townsell**

**Attest:**

\_\_\_\_\_  
**Michael O. Garrett**  
**City Clerk/Treasurer**



## CONWAY PLANNING COMMISSION

1201 OAK STREET CONWAY, AR 72032 (501) 450-6105

May 17, 2011

Council Members  
Conway, AR 72032

Dear Council Members:

Conway Regional Health Foundation request for rezoning from R-2A to S-1 for property located at 605, 615, and 725 Donaghey Avenue; 2111 and 2117 Louvenia Avenue; 2118 and 2120 Ada Avenue; 720 Western Avenue; 2229 Robinson Avenue; and 2135 Caldwell Street with the legal description:

E 40' of the S 93' of Lot 14, and the S 93' of Lots 15 and 16, Block D, Smith's Subdivision; S 100' of Lots 1, 2, and 3, Block A, Smith's Subdivision; Lots 3, 4, and 5 Block D, Smith's Subdivision; S 93' of Lot 13, and the S 93' of the W 10' of Lot 14, Block D, Smith's Subdivision; Lots 11 and 12, Block D, Smith's Subdivision; N 115' of Lot 10, Block B, and the N128' of Lot 9, Block B, Smith's Subdivision; W 1/2 of Lot 7, and all of Lot 8, Block B, Smith's Subdivision; and the E 70' of the W 150' of Lot 3, B.G. Wilson's Map of Conway.

was reviewed by the Planning Commission at its regular meeting on May 16, 2011. The Planning Commission voted 6 – 0 that the request be sent to the City Council with a recommendation for approval.

Submitted by,

Kent Mathis, Chairman  
Planning Commission

# CITY OF CONWAY

## CONWAY REGIONAL REZONINGS -- R-2A TO S-1

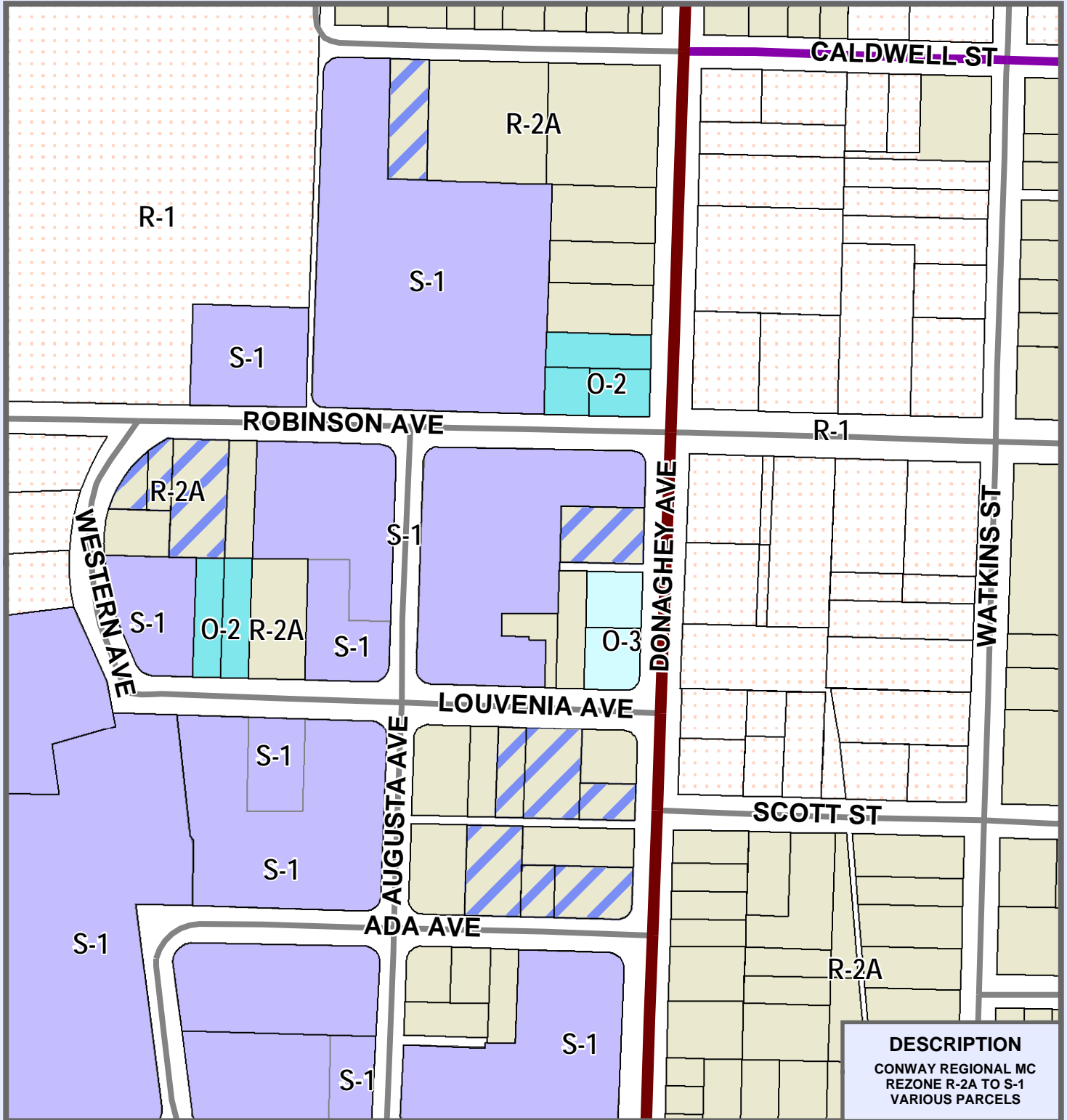

**DESCRIPTION**  
**CONWAY REGIONAL MC**  
**REZONE R-2A TO S-1**  
**VARIOUS PARCELS**

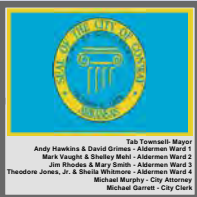

INTERSTATE	LOT LINE	Residential	Industrial
MAJOR ARTERIAL	STREAMS	R-1	MF-1
MINOR ARTERIAL	LAKES & PONDS	R-2A	MF-2
COLLECTOR	CITY LIMITS	R-2	MF-3
RESIDENTIAL		HR	RMH
PRIVATE ROAD		SR	
INTERSTATE RAMP		Commercial	Office
RAILROADS		C-1	O-1
		C-2	O-2
		C-3	O-3
		C-4	Special
			SP
			S-1
			A-1
			PUD

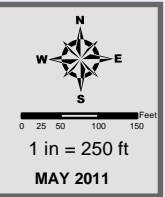

THIS MAP WAS PREPARED BY THE CITY OF CONWAY PLANNING AND DEVELOPMENT DEPARTMENT FOR ITS USE AND MAY BE REVISED AT ANY TIME WITHOUT NOTIFICATION TO ANY USER. THE CITY OF CONWAY PLANNING AND DEVELOPMENT DEPARTMENT DOES NOT GUARANTEE THE CORRECTNESS OR ACCURACY OF ANY FEATURES ON THIS MAP. CITY OF CONWAY ASSUMES NO RESPONSIBILITY IN CONNECTION THEREWITH.

CONTACT INFORMATION  
 LANDMARK GIS WEBSITE  
 gis.cityofconway.org (UNDER DEVELOPMENT)  
 E-MAIL: Jason.Lyon@CityOfConway.org

**MEMORANDUM**

TO: Mayor Tab Townsell

FROM: Ronnie Hall, P.E.  
City Engineer

DATE: May 19, 2011

REFERENCE: Paint Traffic Signal Poles on Oak Street

The appearance of the downtown area could be improved by repainting the traffic signal poles and mast arms black. In an effort to accomplish this goal we requested quotations for repainting the poles and mast arms at Oak - Front, Oak-Chestnut, Oak-Court & Oak - Locust. The request for quotes was sent to our usual traffic signal vendors, DeSoto County Electric, All Service Electric, Inc. and LEG Enterprises, Inc.

The only response to our request for quotations was from DeSoto County Electric in the amount of \$19,800.00. The painting will be performed by brush or roller between 10PM and 6AM with the lane closed under the painting operation.

We are requesting approval to proceed with this work.



**City of Conway, Arkansas**  
**Ordinance No. O-11-\_\_\_\_\_**

**AN ORDINANCE APPROPRIATING FUNDING FOR CIVIL SERVICE EXPENSES; AND FOR OTHER PURPOSES:**

**WHEREAS**, the City of Conway has a need to pay for expenses related to Civil Service Commission expenses and entry police officer testing; for which funding has not previously been provided;

**NOW THEREFORE BE IT ORDAINED BY THE CITY COUNCIL OF THE CITY OF CONWAY, ARKANSAS THAT:**

**SECTION 1.** The City of Conway shall appropriate an amount not to exceed \$9,000 for expenses related to the Civil Service Commission expenses for fire department promotional testing from General Fund, Appropriation Account (001.119.4900) into Civil Service Account (001.119.5770).

**SECTION 2.** All ordinances in conflict herewith are repealed to the extent of the conflict.

**PASSED** this 24<sup>th</sup> day of May, 2011.

**Approved:**

\_\_\_\_\_  
**Mayor Tab Townsell**

**Attest:**

\_\_\_\_\_  
**Michael O. Garrett**  
**City Clerk/Treasurer**

**MEMORANDUM**

**TO:** Mayor Townsell & City Council

**FROM:** Chief Gary

**DATE:** May 18, 2011

**SUBJECT:** Proposed Changes to Civil Service Rules

The Conway Police Department is requesting a public hearing to propose the following changes to the Civil Service Rules as they relate to the hiring and selection process. Item #4 includes more stringent educational requirements. Items 9 and 10 clarify the existing scope of our process as well as the chronological order in which they fall.

Section 2, Qualifications, page seven (7)

#4 (current) High School graduate or possess GED:

#4 (change) Applicants are required to have an Associate degree or 60 hrs of college credit from an educational institution that is accredited by at least one nationally recognized accrediting agency as determined by the U.S. Secretary of Education.

Section 2, Qualification, page eight (8)

#9 (current) successfully complete a physical agility test, psychological examination and post-offer physical examination, including a post-offer drug test.

#9 (change) successfully complete a physical agility test, background investigation. Qualifications Appraisal Board as required by CLEST and a Truth Verification Exam.

#10 (addition) if selected for employment and as a part of a conditional offer of employment, a candidate must successfully complete a psychological exam, a physical exam including vision and hearing and a drug screen.



**City of Conway, Arkansas  
Ordinance No. O-11-\_\_\_\_\_**

**AN ORDINANCE AMENDING ORDINANCES O-05-97 AND O-05-98, ALLOWING FOR ADDITIONAL USES OF TAXES COLLECTED UPON THE GROSS RECEIPTS FROM THE SALE OF PREPARED FOOD AND BEVERAGES FOR THE BENEFIT OF CONWAY PARK FACILITIES; DECLARING AN EMERGENCY; AND FOR OTHER PURPOSES**

**WHEREAS**, pursuant to Ark. Code Ann. § 26-75-602, cities of the first class may, by ordinance levy a tax upon the gross receipts received by restaurants, cafes, cafeterias, delicatessens, drive-in restaurants, carry-out restaurants, concession stands, convenience stores, grocery store-restaurants, and similar business from the sale of prepared food and beverages for on or off-premises consumption, but not applying to organizations qualified under section 501(c)(3) of the federal Internal Revenue Code; and

**WHEREAS**, pursuant to Ark. Code Ann. § 26-75-606, funds generated by such levy may be used, spent, or pledged by the City of Conway Advertising and Promotion Commission (the "Commission") for construction, reconstruction, repair, maintenance, improvement, equipping, and operation of public recreation facilities including but not limited to facilities constituting city parks; and

**WHEREAS**, ordinances O-05-97 and O-05-98 establish A&P Tax No. 1 and A&P Tax No. 2 respectively; and

**WHEREAS**, there exists a formal agreement between the Commission and the City of Conway that designates the proceeds of such tax levy and stipulating that the funds A&P Tax No. 1 and A&P Tax No. 2 will be deposited into a special fund to be used for the development, purchase, and construction of Conway parks to be disbursed by the Mayor upon approval of the City Council; and

**WHEREAS**, all of the proceeds of the 75% portion of A&P Tax No. 1 designated for city parks and recreation facilities and all of the proceeds of A&P Tax No. 2 are pledged to the payment of the City's 2007 Capital Improvement Bonds and are to be deposited with the bond trustee; and

**WHEREAS**, to the extent these proceeds are not used to pay scheduled debt service, they are released by the trustee back to the City; and

**WHEREAS**, Section 1 of ordinance O-07-54 stipulates "The use of surplus collections of A&P Tax No. 1 and A&P Tax No. 2 will be controlled by the provisions of the Advertising and Promotion Commission Act, Ordinance No. O-05-97, Ordinance No. O-05-98 and the trust indenture governing the issuance of and security for the Park Improvement Bonds and the Trail Improvement Bonds."; and

**WHEREAS**, Section 7 of ordinance O-07-54 stipulates "Conditional upon the approval of Question One and/or Question Two set forth in Section 3 hereof at the June 12, 2007 special election, the levy of A&P Tax No. 2, previously limited to three years under the provisions of Section 1 of Ordinance No. O-05-98, shall be extended to the date of final payment of any park improvement bond or trail improvement bonds."; and

**WHEREAS**, contingent upon the Commission amending its formal agreement with the City of Conway, the new agreement will stipulate that the funds generated may also be used for operation and maintenance of public recreation facilities in the City of Conway.

**NOW, THEREFORE, BE IT ORDAINED BY THE CITY COUNCIL OF THE CITY OF CONWAY, ARKANSAS THAT:**

**Section 1.** Section 1 of ordinance O-05-97 is hereby amended to read as follows: "The City of Conway shall levy a one percent (1.00%) tax upon prepared food and beverages as authorized by state law. Of this levy, twenty five percent (or \$0.25) shall be used at the discretion of the Commission, and seventy five percent (or (\$0.75) shall be used by the Commission at the direction of the Mayor upon approval of the City Council for the development, purchase, construction, operation, and maintenance of the Conway parks and recreation facilities.

**Section 2.** Section 1 of ordinance O-05-98 is hereby amended to read as follows: "The City of Conway shall levy a one percent (1.00%) tax upon prepared food and beverages as authorized by state law for a period of time to expire three years subsequent to the effective date of this ordinance for the development, purchase, construction, operation, and maintenance of Conway parks to be disbursed by the Mayor upon approval of the City Council."

**Section 3.** All ordinances in conflict herewith are repealed to the extent of the conflict.

**PASSED** this 24<sup>th</sup> day of May, 2011.

**Approved:**

---

**Mayor Tab Townsell**

**Attest:**

---

**Michael O. Garrett**  
**City Clerk/Treasurer**

**Sponsor:**

---

**Mark Vaught**  
**Alderman Ward 2, Position 1**





City of Conway, Arkansas  
Ordinance No. O-11-\_\_\_\_

**AN ORDINANCE ADOPTING BUDGET ADJUSTMENTS FOR THE PARKS DEPARTMENT AND PROVIDING THAT THE AMOUNTS STATED HEREIN SHALL BECOME APPROPRIATED FROM THE PROPER ACCOUNTS IN THE CITY; DECLARING AN EMERGENCY; AND FOR OTHER PURPOSES**

**WHEREAS**, at the time of the adoption of the budget for the City of Conway for fiscal year 2011, the operations budget of the Parks Department was funded by the General Fund of the City, and

**WHEREAS**, the City Council has adopted ordinance O-11-\_\_\_\_ authorizing revenue from the Parks Department Special Revenue A&P Account (252-000-5800) to be used for the operation and maintenance of parks and recreational facilities in the City of Conway, and

**WHEREAS**, the City Council desires to amend the Parks Department operation budget for fiscal year 2011 to allow partial funding from the Parks Department Special Revenue A&P Account (252-000-5800).

**NOW, THEREFORE, BE IT ORDAINED BY THE CITY COUNCIL OF THE CITY OF CONWAY, ARKANSAS THAT:**

**Section 1.** The Parks Department operating budget for fiscal year 2011 shall be decreased by an amount of \$250,000.

**Section 2.** The mayor is hereby directed to cause the proper accounting entries to be made in the books and records of the City so as to reflect the amendments to the budget for the aforesaid fiscal year.

**Section 3.** All ordinances in conflict herewith are repealed to the extent of the conflict.

**PASSED** this 24th day of May, 2011.

**Approved:**

\_\_\_\_\_  
**Mayor Tab Townsell**

**Attest:**

\_\_\_\_\_  
**Michael O. Garrett**  
City Clerk/Treasurer



City of Conway, Arkansas  
Ordinance No. O-11-\_\_\_\_\_

**AN ORDINANCE ADOPTING BUDGET ADJUSTMENTS FOR THE PARKS DEPARTMENT AND PROVIDING THAT THE AMOUNTS STATED HEREIN SHALL BECOME APPROPRIATED FROM THE PROPER ACCOUNTS IN THE CITY; DECLARING AN EMERGENCY; AND FOR OTHER PURPOSES**

**WHEREAS**, at the time of the adoption of the budget for the City of Conway for fiscal year 2011, the operations budget of the Parks Department was funded by the General Fund of the City, and

**WHEREAS**, the City Council has adopted ordinance O-11-\_\_\_ authorizing revenue from the Parks Department Special Revenue A&P Account (252-000-5800) to be used for the operation and maintenance of parks and recreational facilities in the City of Conway, and

**WHEREAS**, the City Council desires to amend the Parks Department operation budget for fiscal year 2011 to allow partial funding from the Parks Department Special Revenue A&P Account (252-000-5800).

**NOW, THEREFORE, BE IT ORDAINED BY THE CITY COUNCIL OF THE CITY OF CONWAY, ARKANSAS THAT:**

**Section 1.** The Parks Department operating budget for fiscal year 2011 shall be increased by an amount of \$250,000, the funding of which shall be appropriated from the Parks Department Special Revenue A&P Account (252-000-5800).

**Section 2.** The mayor is hereby directed to cause the proper accounting entries to be made in the books and records of the City so as to reflect the amendments to the budget for the aforesaid fiscal year.

**Section 3.** All ordinances in conflict herewith are repealed to the extent of the conflict.

**PASSED** this 24th day of May, 2011.

**Approved:**

\_\_\_\_\_  
**Mayor Tab Townsell**

**Attest:**

\_\_\_\_\_  
**Michael O. Garrett**  
City Clerk/Treasurer



City of Conway, Arkansas  
Ordinance No. O-11-\_\_\_\_\_

**AN ORDINANCE ADOPTING SALARY ADJUSTMENTS FOR CITY EMPLOYEES; DECLARING AN EMERGENCY; AND FOR OTHER PURPOSES**

**WHEREAS**, part of the agreement of employment for the employees of the City of Conway are certain step increases in salaries over a period of time, and

**WHEREAS**, budgetary problems within the General Fund of the City have prevented employees eligible to receive step increases for as many as two years prior, and

**WHEREAS**, there now exists additional revenue in the General Fund of the City to fund one step increase for eligible employees for the remainder of 2011.

**NOW, THEREFORE, BE IT ORDAINED BY THE CITY COUNCIL OF THE CITY OF CONWAY, ARKANSAS THAT:**

**Section 1.** Effective June 1, 2011, all employees of the City of Conway eligible to receive step increases shall have their salaries increased to the proper amount equal to one step increase.

**Section 2.** The mayor is hereby directed to cause the proper accounting entries to be made in the books and records of the City so as to reflect the amendments to the budget for the aforesaid fiscal year.

**Section 3.** All ordinances in conflict herewith are repealed to the extent of the conflict.

**PASSED** this 24th day of May, 2011.

**Approved:**

\_\_\_\_\_  
**Mayor Tab Townsell**

**Attest:**

\_\_\_\_\_  
**Michael O. Garrett**  
City Clerk/Treasurer

**Sponsor:**

\_\_\_\_\_  
**Mark Vaught**  
Alderman Ward 2, Position 1